

2021 ANNUAL MEETING

SSSR Society for the
Scientific Study of Religion



Religious Research
Association **RRA**

PORTLAND, OREGON | OCTOBER 22-24, 2021



HILTON PORTLAND DOWNTOWN & THE DUNWAY FLOOR PLAN

Ballroom Level

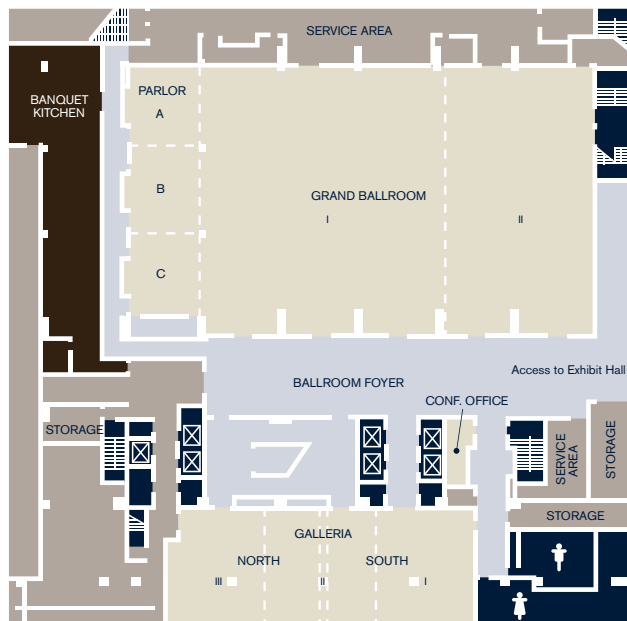

Plaza Level



3rd Floor Conference Level

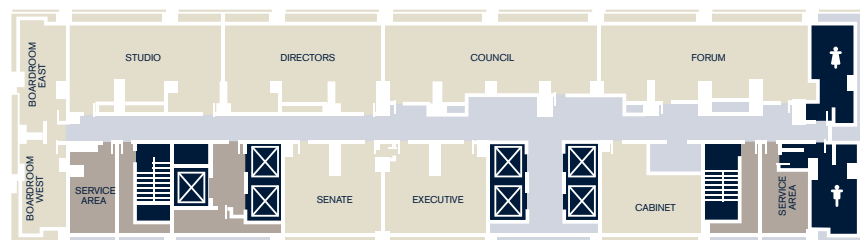

23rd Floor Skyline Level

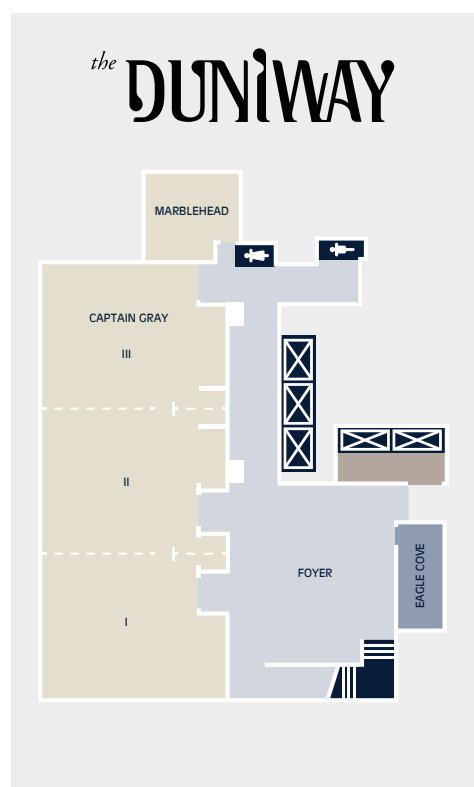
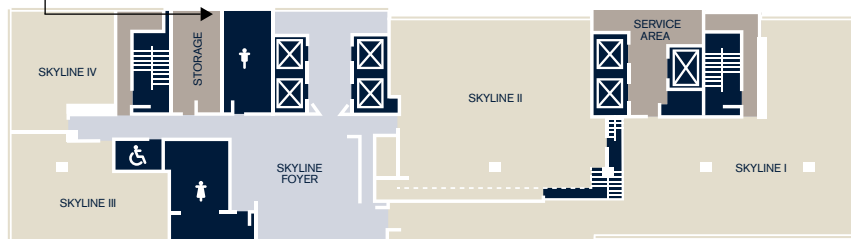

**HILTON PORTLAND DOWNTOWN
& THE DUNIWAY**
921 SW Sixth Avenue | Portland, OR 97204
T: + 1 503 226 1611
F: + 1 503 220 2565
E: pdxph-salesadm@hilton.com
portland.hilton.com

Hilton
PORTLAND DOWNTOWN



SSSR + RRA 2021 PROGRAM SCHEDULE

SSSR PRESIDENT

Prema Ann Kurien

SSSR PROGRAM CHAIRS

Andrea Henderson

Aida Ramos

SSSR EXECUTIVE OFFICER

Karen Hutchison, CAE

@SSSRReligion

RRA PRESIDENT

Melinda Denton

RRA PROGRAM CHAIR

Gina Zurlo

RRA EXECUTIVE OFFICER

Kevin Dougherty

@ReligResearch

#SSSR_RRA21

Conference WiFi password: sssr21

NOVA RELIGIO

THE JOURNAL OF ALTERNATIVE AND EMERGENT RELIGIONS



Nova Religio presents scholarly interpretations and examinations of emergent and alternative religious movements. Original research, perspectives on the study of new religions, literature reviews, and conference updates keep scholars well informed on a wide range of topics including: new religions; new movements within established religious traditions; neo-indigenous, neo-polytheistic and revival movements; ancient wisdom and New Age groups; diasporic religious movements; and marginalized and stigmatized religions.

Editors:

Marie Dallum, Joseph Laycock,
Catherine Wessinger, Benjamin E. Zeller
ISSN: 1092-6690 / eISSN: 1541-8480
Published: August, November, February, May



UNIVERSITY
of CALIFORNIA
PRESS

online.ucpress.edu/nr

PROGRAM OVERVIEW

THURSDAY, OCTOBER 21

11:00 am – 5:00 pm	SSSR Council Meeting	Skyline III
1:00 pm – 5:00 pm	RRA Board Meeting	Skyline IV
5:30 pm – 7:30 pm	Registration Open	Plaza Foyer
8:00 pm – 10:00 pm	Welcome Reception	Plaza Foyer

FRIDAY, OCTOBER 22

7:30 am – 8:30 am	International Scholars Meet and Greet Breakfast	Park Room
7:30 am – 9:00 am	Morning Coffee, Sponsored by RRA	Plaza Foyer
8:00 am – 8:50 am	RRA Business Meeting	Forum Suite
8:30 am – 4:00 pm	Registration	Plaza Foyer
9:00 am – 10:30 am	Paper Session A	
9:30 am – 5:45 pm	Book Exhibit	Atrium Ballroom
10:40 am – 12:10 pm	Paper Session B	
12:10 pm – 1:20 pm	Lunch Break	
1:20 pm – 2:50 pm	Paper Session C	
3:00 pm – 4:30 pm	Paper Session D	
4:45 pm – 5:45 pm	New Books Reception	Atrium Ballroom
5:00 pm – 5:45 pm	Graduate Student Meet and Greet	Park Room
6:00 pm – 7:00 pm	RRA Douglass Lecture	Pavilion West
7:00 pm – 8:00 pm	RRA Reception	Pavilion East
8:00 pm – 8:30 pm	Session in Honor of Jay Demerath	Council Suite
8:45 pm – 10:00 pm	Affinity Group and Research Network Meetings	Council Suite, Forum Suite, Directors Suite, Studio Suite, Senate Suite, Executive Suite, Cabinet Suite, Plaza Suite

SATURDAY, OCTOBER 23

7:30 am – 9:00 am	Morning Coffee, Sponsored by RRA	Plaza Foyer
8:00 am – 8:50 am	SSSR Business Meeting	Forum Suite
8:30 am – 4:00 pm	Registration	Plaza Foyer
9:00 am – 10:30 am	Paper Session E	
9:00 am – 3:00 pm	Book Exhibit	Atrium Ballroom
10:40 am – 12:10 pm	Paper Session F	
12:15 pm – 1:10 pm	Networking Lunch	Skyline I and II
12:15 pm – 1:10 pm	Mormon Social Science Association Meeting	Broadway IV
1:10 pm – 2:10 pm	SSSR Presidential Panel	Pavilion Ballroom
2:20 pm – 3:50 pm	Paper Session G	
4:00 pm – 5:30 pm	Paper Session H	
5:45 pm – 7:00 pm	SSSR Awards & Presidential Address	Pavilion Ballroom
7:00 pm – 9:00 pm	Presidential Reception	Plaza Foyer

SUNDAY, OCTOBER 24

7:30 am – 9:00 am	Morning Coffee, Sponsored by RRA	Plaza Foyer
8:30 am – 10:00 am	Registration	Plaza Foyer
9:00 am – 10:30 am	Paper Session I	
10:40 am – 12:00 pm	Paper Session J	

SSSR STUDENT PAPER AWARD

The SSSR Student Paper Award recognizes the best paper scheduled for presentation by a student at the annual meeting. After students present their papers, they are eligible for the award, which is presented at the following year's annual meeting. The award includes a plaque and \$1,000.

The winner of the 2021 Student Paper Award will be announced at the SSSR Awards and Presidential Address on Saturday, October 23, 2021 at 5:45 p.m. in Pavilion Ballroom.

Nominations may be submitted through the SSSR website (sssreligion.org). Any current member of SSSR may nominate worthy student papers to the Student Paper Award Committee. Students may also self-nominate.

More information about the Student Paper Award is available on the SSSR website.

RECENT AWARDEES

- 2020** **Michael Rotolo** (University of Notre Dame), *"Moral Religiosities: How Morality Structures Religious Understandings During the Transition to Adulthood."*
- 2019** **Laila H. Noureldin** (University of Chicago), *"American v Muslim? Religiosity as a Marker of Fragmented Identification among American Muslims."*
- 2018** **Di Di** (Rice University), *"Navigating Gender Norms: Gender Agency in Buddhist Temples in Mainland China and the US."*
- 2017** Not awarded due to a transition in the timing for the award.
- 2016** **Dane R. Mataic** (Pennsylvania State University), *"Spatial Diffusion of Governmental Restrictions on Religion"*
- 2015** **Grahm Hill** (University of California, Berkeley), *"Reclaiming the Secular: A Charismatic Christian Brotherhood's Interventions on Secularism in Mexico City."*
- 2014** **Landon Schnabel** (Indiana University), *"The Gender Pray Gap."*
- 2013** **Grad Fulton** (Duke University), *"Network Ties and Organizational Action: Explaining Variation in Social Service Provision among Congregations."*
- 2012** **Rachel Ellis** (University of Pennsylvania), *"Marketing to Whom? Desired Members and Jewish Denominational Niches, 1913–1920."*
- 2011** **Katie E. Corcoran, David Pettinicchio, and Blaine Robbins** (University of Washington), *"Religion and the Acceptability of White-Collar Crime: A Cross-National Analysis."*
- 2010** **Christopher A. Bail** (Harvard University), *"Terrified: Social Movements, Emotions, and the Collective Identity of Muslims in the US Media, 2001–2008."*

FRIDAY

OCTOBER 22

7:30 am – 8:30 am	International Scholars Meet and Greet Breakfast	Park Room
7:30 am – 9:00 am	Morning Coffee, Sponsored by RRA	Plaza Foyer
8:00 am – 8:50 am	RRA Business Meeting	Forum Suite
8:30 am – 4:00 pm	Registration	Plaza Foyer
9:00 am – 10:30 am	Paper Session A	
9:30 am – 5:45 pm	Book Exhibit	Atrium Ballroom
10:40 am – 12:10 pm	Paper Session B	
12:10 pm – 1:20 pm	Lunch Break	
1:20 pm – 2:50 pm	Paper Session C	
3:00 pm – 4:30 pm	Paper Session D	
4:45 pm – 5:45 pm	New Books Reception	Atrium Ballroom
5:00 pm – 5:45 pm	Graduate Student Meet and Greet	Park Room
6:00 pm – 7:00 pm	RRA Douglass Lecture	Pavilion West
7:00 pm – 8:00 pm	RRA Reception	Pavilion East
8:00 pm – 8:30 pm	Session in Honor of Jay Demerath	Council Suite
8:45 pm – 10:00 pm	Affinity Group and Research Network Meetings	Council Suite, Forum Suite, Directors Suite, Studio Suite, Senate Suite, Executive Suite, Cabinet Suite, Plaza Suite

RRA BUSINESS MEETING **AGENDA**

Foyer Suite | Friday, October 22, 8:00 AM – 8:50 AM

CALL TO ORDER

PRESIDENT'S REPORT

TREASURER'S REPORT

EXECUTIVE OFFICER'S REPORT AND BUDGET

COMMITTEE REPORTS

Awards Committee
Nominating Committee
Program Committee
Publication Committee
Editor's Report

OLD BUSINESS

RRA Virtual Events

NEW BUSINESS

Introduction of New Executive Officer and Treasurer

ADJOURNMENT

FRIDAY, OCTOBER 22

9:00AM - 10:30AM

PAPER SESSION A

A-1 SSSR: RELIGION AND GLOBAL RESPONSES TO COVID-19

► Room: Broadway II

CONVENER: Chelsea Starr (chelsea.starr@enmu.edu)

Coping up with the Pandemic: A Comparative Analysis of Different Faith Groups in Bangla-desh

Shantanu Majumder, Professor, University of Dhaka, Bangladesh
(shantanu.m@du.ac.bd)

Religiosity and Inter-Country Variations in COVID-19 Incidence

Uzi Rebhun, Hebrew University of Jerusalem (uzi.rebhun@mail.huji.ac.il)

Are They More Alike Than They Realize?

Assessing Religious Differences During a Pandemic

Andrew Franklin, Norfolk State University (asfranklin@nsu.edu)

A-2 SSSR: RETHINKING RELIGIOUS EDUCATION: NEW PERSPECTIVES ON CORE QUESTIONS

► Room: Directors Suite

ORGANIZER/CONVENER:

Erin Johnston, Duke University (erin.johnston1@duke.edu)

The Myth of Jewish Educational Attainment

Ari Kelman, Stanford University (aykelman@stanford.edu)

Is Strict Discipline "Strong"?

Disciplinary Policies in Contemporary Catholic Schools

Carol Ann MacGregor, Loyola, New Orleans (camacgre@loyno.edu)

When America Happens to Good People: Meritocracy as Theodicy

Jeff Guhin, UCLA (guhin@soc.ucla.edu)

Rethinking Theological Education: Emerging Insights into the Nature and Purpose of Divinity School

Josh Gaghan, Duke University (joshua.gaghan@duke.edu)

CO-AUTHOR: David Eagle, Duke University

A-3 SSSR: RELIGION IN DIGITAL SPACES AND TECH

► Room: Broadway III

CONVENER: Tatsushi Hirono, Austin Peay State University
(hironot@apsu.edu)

Beyond Mission, Media and Migration: Global Christianity in Online Marketplaces

Abimbola Adelakun, The University of Texas at Austin
(adelakun@austin.utexas.edu)

The Surprising Spirituality of Silicon Valley: A Content and Discourse Analysis of Wired Magazine, 2001-2020

Paul McClure, University of Lynchburg (mccclure_pk@lynchburg.edu)

CO-AUTHOR 1: Paul McClure, University of Lynchburg

CO-AUTHOR 2: Christopher Pieper, Baylor University

Digital Media and Religion: Connecting Theory and Practice

Steve McMullin, Acadia University (stephen.mcmullin@acadiau.ca)

CO-AUTHOR: Steve McMullin, Acadia University

Seeing Sacred in Tech:

Religion and the Tech Workplace in China and the US

Di Di, Santa Clara University (ddi@scu.edu)

A-4 RRA: FAITH COMMUNITIES TODAY #1 – EXPLORING THE 2020 FAITH COMMUNITIES TODAY RESEARCH FINDINGS

► Room: Park Room

ORGANIZER/CONVENER: Scott Thumma, Hartford Institute for Religion Research
(sthumma@hartsem.edu)

Faith Communities Today 2020: Overview and Methodology

Rich Houseal, Church of the Nazarene Research Office

(rhouseal@nazarene.org)

Trends within the Catholic Church and between Catholic Congregations and All Faith Communities from the 2010 and 2020 FACT Surveys

Jon Wiggins, Georgetown University, Center for Applied Research in the Apostolate (CARA) (jlw8@georgetown.edu)

CO-AUTHOR: Mary Gautier, Georgetown University, Center for Applied Research in the Apostolate (CARA)

A 2020 portrait of United Church of Christ Congregations

Erica Dollhopf, Director, Center for Analytics, Research & Development, and Data (CARDD) United Church of Christ (dollhopfe@ucc.org)

A-5 SSSR: CONGREGATIONAL RESPONSES TO SOCIAL INEQUALITIES

► Room: Forum Suite

CONVENER: W. King, University of Washington (mxwe@uw.edu)

The Impact of Conspiracy Theories, Misinformation and Religious Beliefs in the Response to the COVID-19 Pandemic in Africa

Okelloh Ogera, St. Paul's University, Kenya (revokellohogera@gmail.com)

When "I" Becomes "We":

Religious mobilization, Local Pilgrimage and Political Protests

Adrian Schiffbeck, West University of Timisoara, Romania

(adrian.schiffbeck@e-uvr.ro)

How Houston Religious Leaders Navigate Race in the Wake of George Floyd's Murder

Rachel Schneider, Rice University, Religion and Public Life Program
(rsv2@rice.edu)

CO-AUTHOR 1: Brenton Kalinowski, Rice University,

Religion and Public Life Program

CO-AUTHOR 2: Elaine Howard Ecklund, Rice University,

Religion and Public Life Program

FRIDAY, OCTOBER 22

9:00AM - 10:30AM

Racism and Racial Reconciliation in the Greek Orthodox Church of North America

Frances Kostarelos, Governors State University (fkostarelos@govst.edu)

A-6 SSSR: RELIGION, GRIEF, AND HEALING PRACTICES

► **Room: Broadway I**

CONVENER: Karl Bailey, (kgbailey@andrews.edu)

"If No One Grieves, No One Will Remember": Religion and the Mourning of Abandoned Babies

Pamela Prickett, University of Amsterdam (prickett@uva.nl)

CO-AUTHOR: Stefan Timmermans, UCLA

Words and Prayers: Language, Religiosity, and Wellbeing in Bereaved Persons' Daily Diaries

Roman Palitsky, Brown University, Department of Psychiatry and Human Behavior, Warren Alpert Medical School (roman_palitsky@brown.edu)

CO-AUTHOR 1: Deanna Kaplan, Brown University, Department of Behavioral and Social Sciences

CO-AUTHOR 2: Daniel Sullivan, University of Arizona Department of Psychology

A Crisis of Spirit and Presence: Transnational Tales of Pentecostal Healing in California and Oaxaca

Michelle Ramirez, University of the Sciences in Philadelphia (m.ramirez@uscience.edu)

What Happens After Someone Dies? Experiential Belief, Narrative Belief, and Grave Sweeping in China

Becky Hsu, Georgetown University (becky.hsu@georgetown.edu)

A-7 SSSR+RRA: CHRISTIANITY AND COVID-19

► **Room: Studio Suite**

CONVENER: Rene Drumm, University of Southern Mississippi (rene.drumm@usm.edu)

Challenges and Opportunities:

Religious Organizations in Houston Respond to COVID-19

Brenton Kalinowski, Rice University (bkalinowski@rice.edu)

Resilient or Reticent?

COVID-19 and Intended Return to Religious Services

Timothy Dacey, University of Massachusetts Boston (timothy.dacey001@umb.edu)

CO-AUTHOR 1: Timothy Dacey, University of Massachusetts, Boston

CO-AUTHOR 2: Evan Stewart, University of Massachusetts, Boston

It's Amish vs. Amish in the Coronavirus Arena and the Telephone Lines Are Jammed

Cory Anderson, Pennsylvania State University (dranderson@amishstudies.org)

CO-AUTHOR 1: Jennifer Anderson, Independent

CO-AUTHOR 2: J.P. Miller, Pennsylvania State University

A-8 SSSR: AUTHOR MEETS CRITICS: HIGH ON GOD: HOW MEGACHURCHES WON THE HEART OF AMERICA

► **Room: Broadway IV**

ORGANIZER/CONVENER: Jason Wollschleger, Whitworth University (jwollschleger@whitworth.edu)

AUTHOR: James K. Wellman, University of Washington (jwellman@uw.edu)

CO-AUTHOR 1: Katie E. Corcoran, West Virginia University

CO-AUTHOR 2: Kate J. Stockly, Boston University

PARTICIPANTS

Jessica Collett, University of California, Los Angeles (collett@soc.ucla.edu)

Scott Draper, College of Idaho (sdraper@collegeofidaho.edu)

Paul Froese, Baylor University (paul_froese@baylor.edu)

Gerardo Marti, Davidson College (gemarti@davidson.edu)

A-9 SSSR: THE NON-RELIGIOUS & NON-DENOMINATIONAL: DECLINE, ANXIETY, & TRUST

► **Room: Council Suite**

CONVENER: Erick Berrelleza, Boston University (ebsj@bu.edu)

Moral Disengagement Theory:

Looking for an Excuse to Avoid Being Charitable

Chetna Patel, Clemson University (zhuoc@clemson.edu)

CO-AUTHOR 1: Randle Villanueva, Clemson University

CO-AUTHOR 2: Zhuo Job Chen, Clemson University

The Social Radius: How Non-Denominational Churches Undercut Trust, Voluntarism, and Altruism

Paul Djupe, Denison University (djupe@denison.edu)

CO-AUTHOR: Ryan Burge, Eastern Illinois University

Lost Lutherans: Perspectives on American Religious Decline

Christopher Suehr, Catholic University/ELCA (07suehr@cua.edu)

Anxious Atheists? Factors that Shape Whether Nonreligious People Find Comfort or Anxiety in their Nonreligion

Jacqui Frost, Rice University (jlf8@rice.edu)

CO-AUTHOR 1: Penny Edgell, University of Minnesota

CO-AUTHOR 2: Mahala Miller, University of Minnesota

A-10 SSSR: MORMONS, METAL, AND MINING

► **Room: Executive Suite**

ORGANIZER: Jana Riess, President, Mormon Social Science Association (riess.jana@gmail.com)

CONVENER: Gary Shepherd, Oakland University, emeritus (shepherd@oakland.edu)

The Church of Jesus Christ of Latter-day Saints and Mining: The Case of Peru

David Knowlton, Utah Valley University (dknowlton@uvu.edu)

Mad Bear at Temple Square: Reflections on Repatriation

Thomas W Murphy, Edmonds College (tmurphy@email.edcc.edu)

FRIDAY, OCTOBER 22

9:00AM - 10:30AM

Mormon Metal: An Andean Mine Mythology in Arequipa, Peru

Jason Palmer, University of California, Irvine
(jasoncharlespalmer@hotmail.com)

A-11 SSSR: WHAT REALLY HAPPENS WHEN PROPHECY FAILS

► **Room: Senate Suite**

ORGANIZER: J. Gordon Melton, Baylor University (jgordon_melton@baylor.edu)

CONVENER: Holly Folk, Western Washington University (holly.folk@wwu.edu)

***The New Apostolic Reformation and
Its Prophets in Comparative Perspective***

J. Gordon Melton, Baylor University (jgordon@linkline.com)

The Longitudinal Study of a Failed Prophecy: The Case of Unarius

Diana Tumminia, California State University Sacramento
(dianatumminia@yahoo.com)

Prophesying Trump's Victory: Examining Mass Prophetic Failure

Stuart Wright, Lamar University (wrightsa@lamar.edu)

Reframing Visions: Trump Prophecies after the 2020 Election

Damon Berry, St. Lawrence University (dberry@stlawu.edu)

A-12 SSSR: RELIGION AND FAMILY

► **Room: Plaza Suite**

CONVENER: Amy Smith, Iowa State University Dept. Of Political Science
(aesmith2@iastate.edu)

***Failing religious transmission and the secular transition.
Evidence from three panel studies***

Jörg Stolz, University of Lausanne (joerg.stolz@unil.ch)

CO-AUTHOR 1: Oliver Lipps, FORS, University of Bern

CO-AUTHOR 2: David Voas, University College London

Muslim Families on the Move:

A Culturally Integrative Approach to Family Violence

Catherine Holtmann, University of New Brunswick (cathy.holtmann@unb.ca)

***Retrospective Measures on Parents' Attendance and Religiosity
in the U.S.: How Far Back Can We Go, and What Does it Tell Us?***

Rachel Bacon, The Center for Mind and Culture (rbacon@mindandculture.org)

***Sources of Example, Guidance,
and Influence for Interfaith Couples***

William D. Stanford, University of Georgia (wds65493@uga.edu)

CO-AUTHOR 1: Loren Marks, Brigham Young University

CO-AUTHOR 2: David Dollahite, Brigham Young University

CO-AUTHOR 3: Justin Hendricks, Brigham Young University

CO-AUTHOR 4: Ted Futris, University of Georgia

BOOK EXHIBIT

9:30 AM – 5:45 PM

Atrium Ballroom

FRIDAY, OCTOBER 22

10:40AM - 12:10PM

PAPER SESSION B

B-1 SSSR: A STRICT CHURCH IN A GLOBAL CULTURAL CONTEXT: A SURVEY OF SEVENTH-DAY ADVENTIST MEMBERS

► Room: Directors Suite

ORGANIZER: Karl Bailey, Andrews University (kgbailey@andrews.edu)

CONVENER: Duane McBride, Andrews University (mcbride@andrews.edu)

Religious Belief and Culture:

The Curious Case of the Intuitive Soul

Karl Bailey, Andrews University (kgbailey@andrews.edu)

CO-AUTHOR 1: Duane McBride, Andrews University

CO-AUTHOR 2: David Trim, General Conference of Seventh-day Adventists-- Archives, Statistics, and Research

Pastoral Caring and Visitation: How Cultural Context Intersects with Church Member Perceptions

René Drumm, University of Southern Mississippi (rene.drumm@usm.edu)

CO-AUTHOR 1: Shannon Trecartin, Andrews University

CO-AUTHOR 2: Petr Cincala, Andrews University

Unity or Uniformity? How Cultural Context Helps Define Unity

Petr Cincala, Andrews University (cincala@andrews.edu)

CO-AUTHOR 1: René Drumm, University of Southern Mississippi

CO-AUTHOR 2: Shannon Trecartin, Andrews University

Salvation by Faith or Works:

The Impact of Cultural Factors on Theological Beliefs

Duane McBride, Andrews University (mcbride@andrews.edu)

CO-AUTHOR 1: Petr Cincala, Andrews University

CO-AUTHOR 2: Karl Bailey, Andrews University

B-2 SSSR: INTRODUCING THE NATIONAL SURVEY OF RELIGIOUS LEADERS

► Room: Broadway III

ORGANIZER/CONVENER: Mark Chaves, Duke University (mac58@duke.edu)

The National Survey of Religious Leaders: Background, Methods, and Selected Results

Mark Chaves, Duke University (mac58@duke.edu)

Clergy and Politics

Joseph Roso, Duke University (joseph.roso@duke.edu)

Gender Differences among Clergy

Anna Holleman, Duke University (anna.holleman@duke.edu)

Clergy Health and Well-Being

David Eagle, Duke University (david.eagle@duke.edu)

CO-AUTHOR: Anna Holleman, Duke University

B-3 SSSR: AUTHOR MEETS CRITICS: THE SAINTS OF SANTA ANA: FAITH AND ETHNICITY IN A MEXICAN MAJORITY CITY

Room: Park Room

ORGANIZER: Jonathan Calvillo, Boston University School of Theology

(calvillo@bu.edu)

CONVENER: Aida Ramos, University of Mary-Hardin Baylor (aramos@umhb.edu)

AUTHOR: Jonathan Calvillo, Boston University School of Theology

(calvillo@bu.edu)

PARTICIPANTS

Melissa Guzman, San Francisco State University (mguz@sfsu.edu)

Jerry Park, Baylor University (jerry_park@baylor.edu)

Erica Ramirez, Auburn Seminary (eramirez@auburnseminary.org)

Erick Berrelleza, Santa Clara University (eberrelleza@scu.edu)

B-4 RRA: THE EFFECTS OF CHRISTIAN HIGHER EDUCATION ON STUDENTS' FAITH AND CHARACTER

► Room: Forum Suite

ORGANIZER: Kevin Dougherty, Baylor University (kevin_dougherty@baylor.edu)

Factors Associated with Vertical and Horizontal Faith Maturity at a Christian University

Jason Burt, Baylor University (jason_burt1@baylor.edu)

CO-AUTHOR: Rory Jones, Baylor University

Student-Athletes' Religious Beliefs, Religious Behaviors, and Religious Identity at a Christian University

Daniel Allen, Baylor University (daniel_allen1@baylor.edu)

CO-AUTHOR: Sean Strehlow, Baylor University

Race, Religion, and Belonging at a Christian University

Michael Ryan, Baylor University (michael_ryan1@baylor.edu)

CO-AUTHOR: Hannah Evans, (Hannah_Evans1@baylor.edu)

Shifts in Political Identity and Religiosity for Students at a Christian University

Brandon Brown, Baylor University (brandon_brown1@baylor.edu)

B-5 SSSR: RELIGION AND GENDER I

Room: Broadway I

CONVENER: Angela McCarthy, (angelamccarthy@ufl.edu)

Messages about Motherhood: Gendered Rhetoric and Practice in Protestant Worship Services on Mother's Day

Lisa Pearce, University of North Carolina at Chapel Hill (ldpearce@unc.edu)

CO-AUTHOR 1: Lisa Pearce, University of North Carolina at Chapel Hill

CO-AUTHOR 2: Johannah Palomo, University of North Carolina at Chapel Hill

Feminism, Feminists, and Faith: Intersectional Identities

Amanda Hernandez, Baylor University (amanda_hernandez4@baylor.edu)

FRIDAY, OCTOBER 22

10:40AM - 12:10PM

Women's Ordination: A Meta-Analysis of Catholic Women's Attitudes in the United States

Jennifer Sherman, Georgetown University (jms354@georgetown.edu)

CO-AUTHOR: Mark Gray, Georgetown University

Christian Authoritarianism: Masculine Authority, Charismatic Leadership, and the Rejection of Routinization

Jennifer McKinney, Seattle Pacific University (mckinj@spu.edu)

B-6 SSSR+RRA: CONGREGATIONAL STUDIES

► **Room: Studio Suite**

CONVENER: Suzanne Macaluso, Abilene Christian University

(suzie.macaluso@acu.edu)

Congregations of a Feather?

Exploring Homophily in a Network of Religious Congregations

Jennifer McClure, Samford University (jmccclure@samford.edu)

New-comers, Mergers and Disappearances.

The evolution of religious diversity in the light of two National Congregations Censuses (2009 - 2021)

Jeremy Senn, Université de Lausanne (jeremy.senn@unil.ch)

CO-AUTHOR 1: Jörg Stolz, Université de Lausanne

CO-AUTHOR 2: Christophe Monnot, Université de Strasbourg

Factors Predicting Attending Multiple Congregations in the United States

Stephanie House-Niamke, West Virginia University

(houseniamkes@mix.wvu.edu)

CO-AUTHOR: Katie Corcoran, West Virginia University

B-7 SSSR: RELIGION AND SECULARIZATION

► **Room: Broadway IV**

CONVENER: Andy Bunnell, (abunnell@uw.edu)

Secularization by Replacement Cohort Decline in Switzerland: a Discussion Based on the Swiss Household Panel (SHP)

Christophe Monnot, University of Strasbourg & University of Lausanne

(cmonnot@unistra.fr)

CO-AUTHOR: Boris Wernli, FORS, University of Lausanne

Reactive Populism and Perceived Colonization: Right-Wing Secularization in Germany

Anthony Albanese, Pennsylvania State University (aka5972@psu.edu)

Smart and Spiritual: The Coevolution of Religion and Rationality

Laurence Iannaccone, Chapman University, Institute for the Study of

Religion, Economics & Culture (larry.iannaccone@gmail.com)

The Christian Orthodox Debate on Religious Freedom. A Context-grounded Approach to the Moldovan Case-Study

Davide N. Carnevale, University of Padova

(davidenicola.carnevale@phd.unipd.it)

B-8 SSSR: PROFESSIONAL DEVELOPMENT: GRANT FUNDING FOR THE SOCIAL SCIENTIFIC STUDY OF RELIGION

► **Room: Council Suite**

ORGANIZER/CONVENER: Gerardo Marti, Davidson College (gemarti@davidson.edu)

Grant Funding for the Social Scientific Study of Religion

Gerardo Marti, Davidson College (gemarti@davidson.edu)

Grant Funding for the Social Scientific Study of Religion

Edwin David Aponte, Executive Director, Louisville Institute

(eadonte@louisville-institute.org)

B-9 SSSR: AFRICAN MEGACHURCHES IN THE ERA OF COVID-19: INSIGHTS FROM NIGERIA, GHANA AND KENYA

► **Room: Executive Suite**

ORGANIZER: Allison Norton, Hartford Seminary (anorton@hartsem.edu)

CONVENER: Afe Adogame, Princeton Theological Seminary

(afe.adogame@ptsem.edu)

Combating COVID-19 and "Possessing the Nations": Insights from Ghana's Megachurches

Felicity Apaah, University of Ghana (feliabraham@yahoo.com)

CO-AUTHOR: Allison Norton, Hartford Seminary

Are Churches Essential Services? Religion, Public Health Policies and the Politicization of Covid19 in East Africa, Kenya

Damaris Parsitau, Egerton University, Kenya (dparsitau@yahoo.com)

CO-AUTHOR: E. Okelloh Ogera, Catholic University

Faith, Politics and Science in Nigeria: Interrogating Local Responses of Megachurches to the COVID-19 Pandemic

Dodeye Williams, University of Calabar (williamsdodeye74@gmail.com)

CO-AUTHOR: Olanike Ogunnowo, University of Ibadan

B-10 SSSR: TIME SPENT IN LOS ANGELES: JEWISH ALTERNATIVES AND ALTERNATIVE JEWS

► **Room: Senate Suite**

ORGANIZER/CONVENER: Bruce Phillips, Hebrew Union College-LA &

USC Center for Religion and Civic Culture (bphillips@huc.edu)

Repairing the World from Los Angeles:

Cosmopolitan parochialism and Jewish activism in LA

Brie Loskota, USC Center for Religion and Civic Culture (blokota@usc.edu)

Are "Bad Jews" Nones?

Jennifer Thompson, California State University, Northridge

(jennifer.a.thompson@csun.edu)

Complicating Jews and Whiteness:

Jews of Color in Los Angeles and the West

Bruce Phillips, Hebrew Union College-LA & USC Center for Religion and

Civic Culture (bphillips@huc.edu)

RESPONDENT

Richard Flory, USC Center for Religion and Civic Culture (rflory@usc.edu)

FRIDAY, OCTOBER 22

10:40AM - 12:10PM

B-11 SSSR: RELIGION, INEQUALITIES AND HEALTH

Room: Plaza Suite

ORGANIZER: Steve Offutt, Asbury Theological Seminary

(stephen.offutt@asburyseminary.edu)

The Changing Face of Christian

Missions in the Twenty First Century

Carrie Miles, Empower International Ministries (carriem@fastmail.com)

Which Culture do They Have? How the Evangelical

Imaginary Uses Social Science for Global Engagement

Gary Adler, Penn State University (gja13@psu.edu)

CO-AUTHOR: Kerby Goff, Penn State University

The Association Between Focused Attention Meditation

and Depression is Mediated by Positive-Negative Affect

Ratio and Moderated by Religiosity.

Chelsea Cooley, New Mexico State University, Department of Public Health

(checooley@gmail.com)

The State of Public Religion in Rural America:

Fractured, Marginalized, and Politicized

Gary Adler, Penn State University (gary.adler@psu.edu)

**B-12 SSSR: RELIGION, PEOPLE OF COLOR,
AND LGBTQ+ NEGOTIATIONS**

► **Room: Broadway II**

CONVENER: Wendy Martin, Trinity International University (wmartin@tiu.edu)

Belongingness and Depression among Sexual Minority LDS:

The Moderating Effect of Internalized Homonegativity

Samuel Skidmore, Utah State University (sam.j.skidmore@gmail.com)

CO-AUTHOR 1: Tyler Lefevor, Utah State University

CO-AUTHOR 2: Frank Dillon, Arizona State University

Negotiating Homosexuality: The Impact of

Denominational Debates and Everyday Encounters on the

Theological Conservatism of Korean Immigrant Methodists

Jeyoul Choi, University of Florida (jeyoul777@gmail.com)

Homosexuality, Same-Sex Marriage, and the

Clergy of the Finnish Lutheran Church

Laura Kallatsa, University of Eastern Finland (laura.kallatsa@uef.fi)

***The Relationship Between Racism-Related Stress, Spirituality and
Anxiety Symptomology in Black Sexual Minority Men (BSMM)***

Kaina Anwar, Rowan University (anwar88@students.rowan.edu)

CO-AUTHOR 1: Jonathan Mathias Lassiter, Rowan University

CO-AUTHOR 2: Kaina Anwar, Rowan University

LUNCH BREAK

12:10 – 1:20 PM

FRIDAY, OCTOBER 22

1:20PM - 2:50PM

PAPER SESSION C

C-1 SSSR AUTHOR MEETS CRITICS: THE GLASS CHURCH: ROBERT H. SCHULLER, THE CRYSTAL CATHEDRAL, AND THE STRAIN OF MEGACHURCH MINISTRY

► Room: Park Room

ORGANIZER/CONVENER: Brian Miller, Wheaton College (brian.miller@wheaton.edu)

AUTHOR: Mark Mulder, Calvin University (mmulder@calvin.edu)

CO-AUTHOR: Gerardo Martí, Davidson College

PARTICIPANTS

Brian Miller, Wheaton College (brian.miller@wheaton.edu)

Tricia Bruce, University of Notre Dame (tbruce@nd.edu)

Jonathan Calvillo, Boston University School of Theology (calvillo@bu.edu)

John Bartkowski, University of Texas at San Antonio
(john.bartkowski@utsa.edu)

C-2 RRA: RELIGIOUS LEADERSHIP AND CLERGY WELLBEING

► Room: Forum Suite

CONVENER: George Yancey, Baylor University (George_Yancey@baylor.edu)

Spiritual Orientations: God, Neighbor, Self

Angie Andriot, Presbyterian Church (U.S.A.) (angie.andriot@pcusa.org)

CO-AUTHOR 1: Angie Andriot, Presbyterian Church (U.S.A.)

CO-AUTHOR 2: Deborah Coe, Evangelical Lutheran Church in America

Belief in a Supportive God, Congregational Support, and Oneself, Offset the Adverse Effects of Poor Health on Psychological Distress

Kevin J. Flannelly, Center for Psychosocial Research (kjflannelly@gmail.com)

CO-AUTHOR 1: Laura T. Flannelly, Center for Psychosocial Research

CO-AUTHOR 2: Christopher G. Ellison, University of Texas at San Antonio

The Vigor and Burden of the Clergy Calling - Measuring Work Wellbeing and Work Orientation among the Clergy in a Longitudinal Perspective

Kati Tervo-Niemelä, University of Eastern Finland (kati.tervo-niemela@uef.fi)

C-3 SSSR: RELIGION AND CONTENDING WITH IMMIGRANT STATUS

► Room: Broadway I

CONVENER: Jared Bok, University of Nevada; Reno (jbok@unr.edu)

Religious Altermobilities: Communal Practices of Immigration Enforcement Resistance

Erick Berrelleza, Santa Clara University (ebsj@bu.edu)

Second Generations Sikhs in North America

Navkiran Kaur, Henry Ford Community College Dearborn, Michigan
(knavkpal@gmail.com)

An Immigrant Paradox among Muslims Americans, and Age, Gender, and Immigrant Considerations Regarding Islamic Religiousness

Salman Ahmad, University of Miami (salmanshaheenahmad@gmail.com)

CO-AUTHOR 1: Merranda McLaughlin, University of Miami

CO-AUTHOR 2: Amy Weisman de Mamani, University of Miami

Religious Fundamentalism and Attitudes toward Islam in the United States and India

Lauren Crane, Wittenberg University (lcrane@wittenberg.edu)

CO-AUTHOR: Shabana Bano, Banaras Hindu University

C-4 RRA: PERSONAL/PROFESSIONAL/POLITICAL: POSITIONALITY AND REFLEXIVITY IN APPLIED RELIGIOUS RESEARCH

► Room: Studio Suite

ORGANIZER/CONVENER: Kristina Lizardy-Hajbi, Iliff School of Theology
(klizardy@iliff.edu)

Edwin Aponte, Louisville Institute (eaoponte@louisville-institute.org)

Christine Sheikh, Metropolitan State University of Denver
(csheikh@msudenver.edu)

Scott Thumma, Hartford Seminary (sthumma@hartsem.edu)

C-5 SSSR: CONTINUITIES AND DISCONTINUITIES IN RELIGIOUS TRANSMISSION ACROSS GENERATIONS (1)

► Room: Senate Suite

ORGANIZER: Roberta Ricucci, University of Turin (roberta.ricucci@unito.it)

CONVENER: Carrie Miles, Empower International (carrie@econzone.com)

The Hidden Transmission of Religion Across Generations: Evidence from the U.S.

Merril Silverstein, Syracuse University (merrils@syr.edu)

CO-AUTHOR 1: Joseph Blankhom, UC Santa Barbara

CO-AUTHOR 2: Maria Brown, University of Syracuse

The Role of Grandparents in the Transmission of Religiosity

Gergely Rosta, Pázmány Péter Catholic University

(rosta.gergely.laszlo@gmail.com)

CO-AUTHOR: Zsuzsanna Szvetelszky, Pázmány Péter Catholic University

Debating Religious Socialization in Italy Between Changes and Continuities

Roberta Ricucci, University of Turin (roberta.ricucci@unito.it)

CO-AUTHOR 1: Ferruccio Biolcati Rinaldi, University of Milan

CO-AUTHOR 2: Renzo Carriero, University of Turin

FRIDAY, OCTOBER 22

1:20PM - 2:50PM

**C-6 SSSR: RELIGION, NATIONALISM, AND
LEGACIES OF COLONIALISM**

► **Room: Council Suite**

CONVENER: Damon Berry, St. Lawrence University (Dberry@stlawu.edu)

***'The First 'New Nation': The Deep Cultural Themes
in American Exceptionalism, and Christian Nationalism***

Rhys Williams, Sociology - Loyola University Chicago (rwilliams7@luc.edu)

Everyday Coloniality: Becoming Muslim in the U.S.

Valentina Cantori, University Of Southern California (cantori@usc.edu)

***A Quantitative Approach to Taiwan Catholics,
Postcolonialism and Chinese-Language Media***

Daniel Lindbergh Lang, University of Nevada, Reno

(daniellang@nevada.unr.edu)

C-7 SSSR: RELIGION'S IMPACT ON ENVIRONMENTAL VIEWS

► **Room: Broadway II**

CONVENER: Jacqui Frost, University of Minnesota (jlf8@rice.edu)

Why are European Churches Greener than American Ones?

Christophe Monnot, University of Strasbourg & University of Lausanne

(cmonnot@unistra.fr)

What We Find In Nature:

Comparing the Religious and Nonreligious

Ryan Cragun, The University of Tampa (ryantcragun@gmail.com)

CO-AUTHOR: Christina Pasca, The University of Tampa

Religion in the Anthropocene:

Eastern Orthodox Theological Discourses and Practice

Frances Kostarelos, Governors State University (fkostarelos@govst.edu)

**C-8 SSSR: PROFESSIONAL DEVELOPMENT PANEL:
PUBLISHING BOOKS AND ARTICLES**

► **Room: Broadway III**

ORGANIZER/CONVENER: Melinda Denton, University of San Antonio

(melinda.denton@utsa.edu)

Paul Djupe, Denison University (djupe@denison.edu)

Lisa Pearce, University of North Carolina Chapel Hill (ldpearce@unc.edu)

Amy McDowell, University of Mississippi (mcdowell@olemiss.edu)

Jason Shelton, University of Texas at Arlington (jeshelton@uta.edu)

FRIDAY, OCTOBER 22

3:00PM - 4:30PM

PAPER SESSION D

D-1 SSSR: RELIGION AND CRIMINAL JUSTICE

► Room: Broadway I

CONVENER: Mark Jackson, (mark.jackson@churchofjesuschrist.org)

A Comparison of the Sociological and Psychological Mechanisms of Religion in Prison Reentry

Iman Said, Pennsylvania State University (ixs228@psu.edu)

CO-AUTHOR: Kimberly Davidson, Pennsylvania State University

From Incarceration to Imancipation:

Blackamerican Muslim Conversion and Reentry

Laila Noureldin, The University of Chicago (lhnoureldin@uchicago.edu)

Refuge of God—For Whom?

Religious Attendance and Fear of Crime in Context

Robert Thomson, The University of Alabama in Huntsville (rat0019@uah.edu)

D-2 SSSR+RRA: SECULARIZATION AND DISAFFILIATION

► Room: Studio Suite

CONVENER: Navkiran Kaur, Henry Ford College (npkaur@hfcc.edu)

Religious (Dis)Affiliation Trends in Theological Education: Student and Faculty Comparisons

Kristina Lizardy-Hajbi, Iliff School of Theology (klizardy@iliff.edu)

How Do Emerging Adult Nones and Dones Make Meaning?

Marjorie Royle, Clay Pots Research (tayloroyle@comcast.net)

CO-AUTHOR 1: Susan Pizor Yoder, Blank Slate

CO-AUTHOR 2: Collaborative Inquiry Team, Lehigh Valley Clergy

Evangelicals' Understanding of Work and the Churches' Understanding of Evangelicals' Work

Wendy L. Martin, Trinity International University (wmartin@tiu.edu)

CO-AUTHOR: Richard E. Phillips,

Ritualizing Nonreligion: Cultivating Rational Rituals in Secular Spaces

Jacqui Frost, Rice University (jlf8@rice.edu)

D-3 SSSR: DIVERSITY IDEOLOGIES AND RELIGION

► Room: Broadway IV

CONVENER: Eric McDaniel, (emcdaniel@austin.utexas.edu)

Islam's Position on Multiculturalism and Racism

Farooq Hassan, NED University of Engineering & Technology Karachi Pakistan (drfarooq68@yahoo.com)

Religion Has No borders: Studying Jews and other Religious Groups around the World

Leonard Saxe, Brandeis University (saxe@brandeis.edu)

CO-AUTHOR: Daniel Parmer, Brandeis University

Asian American Evangelicals on Race and Politics: A Comparative Study On How Chinese-, Korean-, and Filipino-Americans Use Religion To Form Racial Attitudes And Policy Preferences

Bianca Mabute-Louie, Graduate student (bm54@rice.edu)

The Religious Ecology of Superdiversity

Richard Cimino, SUNY-Old Westbury (relwatch1@msn.com)

CO-AUTHOR 1: Richard Cimino, SUNY-Old Westbury

CO-AUTHOR 2: Hans Tokke, CUNY

D-4 SSSR PANEL: SOCIAL SCIENCE PERSPECTIVES ON RELIGION AND CLIMATE CHANGE

► Room: Council Suite

ORGANIZER/CONVENER: Evan Berry, Arizona State University (evan.berry@asu.edu)

The Changing Climate for Religion Research

Evan Berry, Arizona State University (evan.berry@asu.edu)

Seeing Sin in the Amazon:

Clergy Leadership and Public Opinion in Brazil

Amy Erica Smith, Iowa State University (aesmith2@iastate.edu)

CO-AUTHOR 1: Mauricio Moura,

CO-AUTHOR 2: Debora Ziccardi,

Returning to the Gods of the Land

David Haberman, Indiana University (dhaberma@indiana.edu)

Beyond "White" Environmentalism:

Varieties of Latinx Catholic Engagement

Amanda Baugh, California State University Northridge (amanda.baugh@csun.edu)

D-5 SSSR: MAPPING THE SPIRITUAL TURN: CONSOLIDATING THE SOCIOLOGY OF SPIRITUALITY

► Room: Executive Suite

ORGANIZER: Galen Watts, KU Leuven (galen.watts@kuleuven.be)

CONVENER: Dick Houtman, KU Leuven (dick.houtman@soc.kuleuven.be)

The Spiritual is Political:

Self-Realization and the Quest for Social Justice

Galen Watts, KU Leuven (galen.watts@kuleuven.be)

The "Spirits" in Spirituality:

Prevalence, Relationality, and Public Stakes

Candy Gunther Brown, Indiana University (browncg@indiana.edu)

Social and Political Attitudes of Spiritual Seekers

Franz Hollinger, University of Graz (franz.hoellinger@uni-graz.at)

Is Spirituality the New Emic Term for New Age?

Paul Tromp, KU Leuven (paul.tromp@kuleuven.be)

FRIDAY, OCTOBER 22

3:00PM - 4:30PM

D-6 SSSR RELIGION IN HIGHER EDUCATION

► **Room: Broadway II**

ORGANIZER/CONVENER: Jenny Holcombe, University of Tennessee at Chattanooga (Jenny-Holcombe@utc.edu)

Support for Conspiracy Theories in Christian Higher Education: Results from Multiple Surveys

Daniel Bennett, John Brown University (dbennett@jbu.edu)

Food Insecurity and COVID-19 in Higher Education: Comparing Religiously-Affiliated and Non-Religiously Affiliated Universities

Kalina Brenchley, University of Mary Hardin-Baylor (kabrenchley@mail.umhb.edu)

CO-AUTHOR: Aida Ramos, University of Mary Hardin-Baylor

Graduate Student Spirituality at a Christian University

Daniel Allen, Baylor University (daniel_allen1@baylor.edu)

When Race Isn't Important but Racial Reconciliation Is: Racial Differences and Religious Contradictions among Christian Students at Eleven CCCU Campuses.

Esther Chan, University of Wisconsin-Milwaukee (chane@uwm.edu)

CO-AUTHOR: Elijah Jeong, Baylor University

D-7 SSSR: THEORIZING RELIGION, SOCIAL MOVEMENTS, AND SOCIAL CHANGE

► **Room: Senate Suite**

CONVENER: Susan Barnett, PCUSA (susan.barnett@pcusa.org)

Messianic Judaism:

The Formation of a Global Religious Community

Yaakov Ariel, University of North Carolina (yariel@email.unc.edu)

Agency and Institution in Late Modernity from Embedded Organization to Institutional Entrepreneurs in Polish Catholic Parishes

Wojciech Sadlon, Institute for Catholic Church Statistics, Cardinal Stefan Wyszyński University (w.sadlon@iskk.pl)

Hartmut Rosa Goes to Church: Acceleration, Resonance, and the Megachurch Ministry of Robert H. Schuller

Gerardo Marti, Davidson College (gemarti@davidson.edu)

CO-AUTHOR: Mark Mulder, Calvin University

The Buddhist Revival and Legal Registration in Russia, 1991-2021

J. Eugene Clay, Arizona State University (clay@asu.edu)

D-8 SSSR: AUTHOR MEETS CRITICS: BUILDING FAITH: A SOCIOLOGY OF RELIGIOUS STRUCTURES

► **Room: Plaza Suite**

ORGANIZER/CONVENER: Robert Brenneman, Goshen College (rbrenneman@goshen.edu)

AUTHOR: Robert Brenneman, Goshen College (rbrenneman@goshen.edu)

CO-AUTHOR: Brian Miller, Wheaton College

PARTICIPANTS

Sally Gallagher, Oregon State University (sgallagher@oregonstate.edu)

Rory Jones, Baylor University (rory_jones@baylor.edu)

Tricia Bruce, University of Notre Dame (tbruce@nd.edu)

D-9 SSSR: CONTINUITIES AND DISCONTINUITIES IN RELIGIOUS TRANSMISSION ACROSS GENERATIONS (2)

► **Room: Forum Suite**

ORGANIZER: Kati Tervo-Niemelä, University of Eastern Finland (kati.tervo-niemela@uef.fi)

CONVENER: Merril Silverstein, Syracuse University (merrills@syr.edu)

Predicting the Unpredictable: Internal Variations in Canadian Family Religious Transmission Outcomes

Guillaume Boucher, University of Ottawa (gbouche7@uottawa.ca)

CO-AUTHOR: Alyshea Cummins, University of Ottawa

Faith as a Source of Strength, but even more as Responsibility - Continuities and Discontinuities across Three Generations in German Families

Christel Gärtner, University of Münster (cgaer_01@uni-muenster.de)

CO-AUTHOR: Linda Hennig, University of Münster

Complexities in Religious Transmission - the Case of Finland

Kati Tervo-Niemelä, University of Eastern Finland (kati.tervo-niemela@uef.fi)

CO-AUTHOR 1: Jenni Spännäri, University of Eastern Finland

CO-AUTHOR 2: Laura Kallatsa, University of Eastern Finland

NEW BOOKS RECEPTION

FRIDAY, OCTOBER 22 : 4:45 PM – 5:45 PM

Atrium Ballroom

Refreshments will be served during the reception.

The New Books Reception is an opportunity to showcase new work in the scientific study of religion.

AUTHORS

SALMAN SHAHEEN AHMAD

Culturally Informed Therapy for Schizophrenia
(Oxford University Press, 2020)

NANCY AMMERMAN

Studying Lived Religion
(NYU Press, 2021)

ANTHONY J. BLASI

An Urban Ecological Sociology of Religion: The Case of San Antonio, Texas
(Mellen Press, 2021)

R. KHARI BROWN, RONALD E. BROWN, and JAMES S. JACKSON

Race and the Power of Sermons on American Politics
(University of Michigan Press, 2021)

GAIL CAFFERATA

The Last Pastor
(Westminster John Knox Press, 2020)

SUSAN J. PALMER

The Mystical Geography of Quebec: Catholic Schisms and New Religions
(Palgrave Macmillan, 2020)

LISA D. PEARCE and CLAIRE CHIPMAN GILLILAND

Religion in America
(University of California Press, 2020)

GORDON SHEPHERD and GARY SHEPHERD

*Growing Up in the City of the Saints:
Glimpses of America in Salt Lake City During the 1950s and 60s*
(BookBaby, 2021)

STUART A. WRIGHT

The Demise of Religion
(Bloomsbury Publishing, 2020)

NEW BOOK RECEPTION SPONSOR

NEW YORK UNIVERSITY PRESS

GRADUATE STUDENT MEET AND GREET

FRIDAY, OCTOBER 22, 5:00 PM - 5:45 PM
Park Room

Check out the New Books Reception
and then join your fellow graduate students
for networking and conversation.

ORGANIZED BY 2021 SSSR
STUDENT AMBASSADOR:

IVY ALEXANDRA RAINES
Syracuse University
(iaraines@syr.edu)

RRA DOUGLASS LECTURE

FRIDAY, OCTOBER 22
6:00 PM - 7:00 PM
Pavilion West

*The Meaning of American
Progress: Race, Science,
and Redemption*

NICHOLE R. PHILLIPS
Emory University
(nichole.r.phillips@emory.edu)

SPECIAL SESSION

in memory of
JAY DEMERATH

FRIDAY, OCTOBER 22
8:00 PM - 8:30 PM
Council Suite

ORGANIZED/CONVENED BY :

RHYS H. WILLIAMS
Loyola University Chicago
(rwilliams7@luc.edu)

MARK CHAVES, Duke University
NANCY T. AMMERMAN, Boston University
JAMES T. RICHARDSON, University of Nevada, Reno

RRA RECEPTION

FRIDAY, OCTOBER 22
7:00 PM - 8:00 PM
Pavilion East

AFFINITY GROUP AND RESEARCH NETWORK MEETINGS

FRIDAY, OCTOBER 22, 8:45 PM – 10:00 PM

CATHOLIC RESEARCH NETWORK

► Room: Council Suite

The meeting of the Catholic Research Network will include a discuss of the topics of interest to those attending.

CONTACT: Pierre Hégy (pierre.hegy@gmail.com)

NON-RELIGION GROUP

► Room: Forum Suite

This is a group for those interested in the myriad ways that non-religion shows up in the United States and globally.

CONTACT: Ryan Cragun (ryantcragun@gmail.com)

ISLAM RESEARCH NETWORK

► Room: Directors Suite

This is an informal discussion and networking opportunity for researchers who study Islam.

CONTACT: Besheer Mohamed (BMohamed@PewResearch.org)

MORMON SOCIAL SCIENCE ASSOCIATION (MSSA)

► Room: Studio Suite

MSSA exists for the purpose of promoting and sharing the scholarly study of Mormon life. We provide contact and association among researchers and educators working in both academic and applied settings, and are both interdisciplinary and international in scope and purpose.

CONTACTS: Carrie Miles (CarrieM@fastmail.com)

SCHOLARS OF COLOR NETWORK

► Room: Senate Suite

This networking event is for Scholars of Color (SoC) within the SSSR. We believe the more robust and vibrant connections are made when genuine relationship is the foundation; therefore, we seek to provide an environment where SoC can discuss and enhance the visibility of their work, receive support, and unwind.

CONTACTS: Aida Ramos (aramos@umhb.edu)

CONGREGATIONAL SCHOLARS NETWORK

► Room: Executive Suite

This is an opportunity for those interested in congregational research to meet and get acquainted.

CONTACTS: Kevin Dougherty (Kevin_Dougherty@baylor.edu)

SOCIAL SCIENCE OF SCIENCE AND RELIGION GROUP

► Room: Cabinet Suite

This group promotes empirical social science research on the relationship between science and religion.

CONTACT: Elaine Howard Ecklund (ehc@rice.edu)

RELIGION AND CIVIC LIFE

► Room: Plaza Suite

This is a group for scholars interested in the intersection of religion with politics, voluntarism, and other forms of civic life.

CONTACT: Paul A. Djupe (djupe@gmail.edu)

SATURDAY

OCTOBER 23

7:30 am – 9:00 am	Morning Coffee, Sponsored by RRA	Plaza Foyer
8:00 am – 8:50 am	SSSR Business Meeting	Forum Suite
8:30 am – 4:00 pm	Registration	Plaza Foyer
9:00 am – 10:30 am	Paper Session E	
9:00 am – 3:00 pm	Book Exhibit	Atrium Ballroom
10:40 am – 12:10 pm	Paper Session F	
12:15 pm – 1:10 pm	Networking Lunch	Skyline I and II
12:15 pm – 1:10 pm	Mormon Social Science Association Meeting	Broadway IV
1:10 pm – 2:10 pm	SSSR Presidential Panel	Pavilion Ballroom
2:20 pm – 3:50 pm	Paper Session G	
4:00 pm – 5:30 pm	Paper Session H	
5:45 pm – 7:00 pm	SSSR Awards & Presidential Address	Pavilion Ballroom
7:00 pm – 9:00 pm	Presidential Reception	Plaza Foyer

SSSR BUSINESS MEETING **AGENDA**

Forum Suite | Saturday, October 23, 8:00 AM – 8:50 AM

WELCOME AND INTRODUCTION OF OFFICERS

STRATEGIC PLAN OVERVIEW AND PROGRESS REPORT

TREASURER'S REPORT

EXECUTIVE OFFICER'S REPORT

JOURNAL EDITOR'S REPORT

SATURDAY, OCTOBER 23

9:00AM - 10:30AM

PAPER SESSION E

E-1 SSSR: RELIGION, DISCRIMINATION, AND POLITICS

► Room: Broadway III

CONVENER: Jonathan Calvillo, Boston University School of Theology
(calvillo@bu.edu)

The Effects of Congregational Composition on Perceptions of Discrimination and Attitudes towards Racially Focused Social Issues.

Brandon Martinez, Providence College (bmartine@providence.edu)
CO-AUTHOR: Joshua Tom, Seattle Pacific University

Social Conservatives and the Democratic Party

Besheer Mohamed, Pew Research Center (bmohamed@pewresearch.org)
CO-AUTHOR: Youssef Chouhoud

Intergroup Contact as an Intervention for Political Prejudice

Matthew Durham, University of Tennessee at Chattanooga
(matthew-durham@utc.edu)

E-2 SSSR: RELIGIOUS PRACTICE AND BOUNDARY MAKING

► Room: Park Room

CONVENER: Becky Hsu, Georgetown University (becky.hsu@georgetown.edu)

Typology of Religion: The Adherent Driver Matrix

Wendy Martin, Trinity International University (wmartin@tiu.edu)

Contemporary Pagans and Christian Boundary Maintenance

Chelsea Starr, Eastern New Mexico University (chelseastarr@gmail.com)

Religious Openness to Secularism (ROSE): A Musical Experiment in an Examination of the Analytic Thinking-Religiosity Relationship

Victoria Cline, Clemson University (zhuoc@clemson.edu)
CO-AUTHOR 1: Randle Villanueva, Clemson University
CO-AUTHOR 2: Zhuo Job Chen, Clemson University

The Influence of Demographic Characteristics on Grave Sweeping in China

Becky Hsu, Georgetown University (becky.hsu@georgetown.edu)
CO-AUTHOR: Joseline Lu, Columbia University

E-3 SSSR: RELIGIOUS INTERACTION RITUALS

► Room: Broadway I

ORGANIZER/CONVENER: Scott Draper, The College of Idaho
(sdraper@collegeofidaho.edu)

The Black Church, Emotional Energy and Civil Right Organizing in Birmingham, AL 1961-1963

Jason Wollschleger, Whitworth University (jwollschleger@whitworth.edu)

In What Ways do Evangelicals' IR's Hide Racism and Sexism?

James Wellman, University of Washington (jwellman@uw.edu)

The Wedding of Prince William and Kate Middleton as Dynastic Drama

Pierre Hegy, Adelphi University (pierre.hegy@gmail.com)

Worshipping Vicariously:

Religious Gatherings during the COVID-19 Pandemic

Brandon Brown, Baylor University (brandon_brown1@baylor.edu)

E-4 SSSR: RELIGION, VIOLENCE, GUNS, & EXTREMISM

► Room: Broadway IV

CONVENER: Shaonta' Allen, (allen3se@mail.uc.edu)

Preaching on Pistols: An Experiment Assessing the Influence of Clergy on Gun Policy Attitudes

Abigail Vegter, University of Kansas (abigailvegter@ku.edu)

Sacred Sites and Conflict Intractability:

Towards A New Theoretical Understanding

Chirasree Mukherjee, Arizona State University (cmukher1@asu.edu)

Preaching and Gun Issues: Clergy and Congregation Responses

Leah Schade, Lexington Theological Seminary (lschade@lextheo.edu)
CO-AUTHOR: Katie Day, United Lutheran Seminary

Beyond Religious Terrorism: Perceptions of extremism among University students in Bangladesh

Helal Hossain Dhali, McGill University
(helaldhali@gmail.com; helal.dhali@mail.mcgill.ca)

E-5 RRA: PLAIN PERCEPTIONS: THE AMISH AND MENNONITE RESPONSE TO THE COVID-19 PANDEMIC

► Room: Council Suite

ORGANIZER: Katie Corcoran, West Virginia University (kecorcoran@mail.wvu.edu)

Rituals of Contagion in Closed Religious Communities: A Case Study of Amish and Mennonite Communities during the COVID-19 Pandemic

Sara Guthrie, West Virginia University (sg0067@mix.wvu.edu)

CO-AUTHOR 1: Katie Corcoran, West Virginia University

CO-AUTHOR 2: Rachel Stein, West Virginia University

Closed but not protected: Excess deaths among the Amish and Mennonites during the COVID-19 pandemic

Rachel Stein, West Virginia University (rachel.stein@mail.wvu.edu)

CO-AUTHOR 1: Katie Corcoran, West Virginia University

CO-AUTHOR 2: Corey Colyer, West Virginia University

'When the Waves Roll High': Religious Coping among the Amish During the COVID-19 Pandemic

Bernard DiGregorio, West Virginia University (bdigregio@mix.wvu.edu)

CO-AUTHOR 1: Katie Corcoran, West Virginia University

CO-AUTHOR 2: Rachel Stein, West Virginia University

SATURDAY, OCTOBER 23

9:00AM - 10:30AM

Global Contexts: How Countries Shape the COVID-19 Experience of Amish/Mennonite Missionaries Abroad

Corey Colyer, West Virginia University (corey.colyer@mail.wvu.edu)

CO-AUTHOR 1: Rachel Stein, West Virginia University

CO-AUTHOR 2: Katie Corcoran, West Virginia University

**E-6 SSSR: JEHOVAH'S WITNESSES:
CHALLENGES OF A BORDERLESS COMMUNITY**

► **Room: Executive Suite**

ORGANIZER/CONVENER: J. Gordon Melton, Baylor University

(jgordon_melton@baylor.edu)

Fighting to Live at Peace:

Jehovah's Witnesses During World War II

J. Gordon Melton, Baylor University (jgordon_melton@baylor.edu)

Persecuting Apolitical Jehovah's Witnesses:

Russia's Paradoxical Path and the Export of Its

Religio-Political Ideologies to Former Soviet Spaces

Jarrod Lopes, Watch Tower Bible and Tract Society (WTBTS) (jlopes@jw.org)

The Jehovah's Witnesses and Progressive Jurisprudence:

The Cultural Meaning of Recent Court Decisions in Canada

Holly Folk, Western Washington University (holly.folk@wwu.edu)

E-7 SSSR: CONSPIRACY AND CHRISTIAN NATIONALISM

► **Room: Forum Suite**

CONVENER: Esther Chan, Yale University (chane@uwm.edu)

QAnon and the American Religious Landscape:

Engaging Critical Theory

Sarah MacMillen, Duquesne University (macmillens@duq.edu)

CO-AUTHOR: Timothy Rush, Duquesne University

Christian Nationalism and Political Violence:

Victimhood, Conspiracy and Support for the Capitol Attacks

David Buckley, University of Louisville (david.buckley@louisville.edu)

CO-AUTHOR 1: Adam Enders, University of Louisville

CO-AUTHOR 2: Miles Armaly, University of Mississippi

Recruitment to QAnon: Ordinary Persuasion or "Brainwashing"?

James Richardson, University of Nevada, Reno (jtr@unr.edu)

E-8 SSSR: MEASURING RELIGIOUS CHANGE, PRACTICE, AND RELIGIOSITY

► **Room: Broadway II**

CONVENER: Patricia Tevington, University of Pennsylvania

(ptevington@gmail.com)

Beyond Piety and Politics:

Religion, Public Preferences, and State-Society Relations in MENA

Sabri Ciftci, Kansas State University (ciftci@ksu.edu)

CO-AUTHOR 1: Michael Wuthrich, University of Kansas

CO-AUTHOR 2: Ammar Shamaileh, Doha Institute for Graduate Studies, Qatar

Modeling Religious Change in India from Quantitative, Qualitative, and Historical Perspectives

Gina Zurlo, Gordon-Conwell Theological Seminary (gzurlo@gordonconwell.edu)

CO-AUTHOR: David Hannan, Gordon-Conwell Theological Seminary

Relating Religious and Spiritual Practice to Civic and Political Engagement in the United States

Evan Stewart, University of Massachusetts Boston (evan.stewart@umb.edu)

CO-AUTHOR: Jaime Kucinkas, Hamilton College

Sunday Morning Shifts:

Religious Practice in Time Use, 2003-2019

Ken Arsenault, University of Massachusetts, Boston

(kenneth.arsenault002@umb.edu)

CO-AUTHOR 1: Evan Stewart, University of Massachusetts, Boston

CO-AUTHOR 2: Ken Arsenault, University of Massachusetts, Boston

E-9 SSSR: WHAT ARE THE CONSEQUENCES OF SECULARIZATION?

► **Room: Directors Suite**

ORGANIZER: Ryan Cragun, The University of Tampa (ryantcragun@gmail.com)

CONVENER: Jesse Smith, Western Michigan University (jesse.smith@wmich.edu)

PANELISTS

David Voas, University College London (d.voas@ucl.ac.uk)

Joel Thiessen, Ambrose University (jathiessen@ambrose.edu)

Phil Zuckerman, Pitzer College (phil_zuckerman@pitzer.edu)

BOOK EXHIBIT

9:00 AM – 3:00 PM

Atrium Ballroom

SATURDAY, OCTOBER 23

10:40AM - 12:10PM

PAPER SESSION F

F-1 SSSR: RELIGIOUS CHANGE AND SPIRITUAL WELL-BEING AMONG CLERGY

► Room: Broadway III

CONVENER: Brandon Martinez, Providence College (bmartine@providence.edu)

Spiritual Border Crossing Denied:

Doreen Virtue's 'New Age to Christian' Conversion Scandal

Madeline Duntley, Bowling Green State University (dmadeli@bgsu.edu)

Does Religious Upbringing Predict Clergy's Spiritual Wellbeing?

Todd Ferguson, University of Mary Hardin-Baylor (tferguson@umhb.edu)

CO-AUTHOR 1: Glen Milstein, The City College of The City University of New York

CO-AUTHOR 2: Jia Yao, Duke University

From Minister to Nonbeliever: Ex-clergy Demonstrate the Pitfalls of Communicating a Nonreligious Identity

Dan Delaney, University of Louisville (dan.delaney@louisville.edu)

Response to a Crisis: A Network Analysis of Support for Clergy

Thad Austin, Duke University (taustin@div.duke.edu)

CO-AUTHOR: Katie Comeau, Duke University

F-2 RRA: FAITH COMMUNITIES TODAY #2 – 2020 DENOMINATIONAL RESULTS

► Room: Directors Suite

ORGANIZER: Scott Thumma, Hartford Institute for Religion Research

(sthumma@hartsem.edu)

The 2020 Nondenominational Church Reality: Strong and Growing

Scott Thumma, Hartford Institute for Religion Research

(sthumma@hartsem.edu)

A 2020 Portrait of Megachurch Congregations

Warren Bird, VP of Research and Equipping Evangelical Council for Financial Accountability (warren@ecfa.org)

CO-AUTHOR: Scott Thumma, Hartford Institute for Religion Research

A 2020 Portrait of Orthodox Christian Churches

Alexei Krindatch, Coordinator National Census of Orthodox Christian Churches 2020 US Religion Census (akrindatch@aol.com)

A 2020 Picture of Baha'i Congregations

Mike McMullen, Department of Sociology University of Houston-Clear Lake (mcmullen@uhcl.edu)

F-3 RRA: GENERATIONS OF RELIGIOUS RESEARCH(ERS)

► Room: Forum Suite

ORGANIZER/CONVENER: Patricia Wittberg, Center for Applied Research in the Apostolate Georgetown University (pwittber@iupui.edu)

PANELISTS

Mary Gautier, Center for Applied Research in the Apostolate (gautierm@georgetown.edu)

Jared Bok, University of Nevada (jbok@unr.edu)

Kerby Goff, Penn State University (kerby.goff@psu.edu)

Elaine Ecklund, Rice University (hjh2@rice.edu)

F-4 SSSR: THEORY AND TERMINOLOGY IN MORMON STUDIES

► Room: Broadway IV

ORGANIZER: Jana Riess, President, Mormon Social Science Association (riess.jana@gmail.com)

CONVENER: Rick Phillips, University of North Florida (phillips.rick@gmail.com)

"Are We Apostates?": The Use of the Term Apostate in a Large Online Ex-Mormon Community

Levi Sands, University of Iowa (levi-sands@uiowa.edu)

How Diffusion of Innovation Theory, Labeling Theory, Ascription Theory, and Schema Theory Explain the Social Dynamics Surrounding Joseph Smith's Treasure Quest

Manuel Padro, Independent scholar (mpadro23@gmail.com)

Deconversion Narratives:

Language and the Loss of Faith among Former Mormons

Jana Riess, Religion News Service (riess.jana@gmail.com)

F-5 SSSR: PEW RESEARCH CENTER'S 2020 SURVEY OF JEWISH AMERICANS

► Room: Council Suite

ORGANIZER: Becka A. Alper, Pew Research Center (balper@pewresearch.org)

Predictors of religious and cultural engagement and Jewish identification in adulthood

Becka A. Alper, Pew Research Center (balper@pewresearch.org)

CO-AUTHOR: Alan Cooperman, Pew Research

The Hollow Middle:

Young Jews are More Secular and More Orthodox

Ariela Keysar, Trinity College (akeysar@aol.com)

Economic vulnerability among American Jews:

Measures, predictors, consequences

Laurence Kotler-Berkowitz, Jewish Federations of North America (laurence.kotler-berkowitz@jewishfederations.org)

SATURDAY, OCTOBER 23

10:40AM - 12:10PM

Judaism is not only a religion:

Patterns of Engagement with Jewish Identity

Leonard Saxe, Brandeis University (saxe@brandeis.edu)

F-6 SSSR: RELIGION AND YOUTH

Room: Skyline IV

CONVENER: Lauren Crane, Wittenberg University (lcrane@wittenberg.edu)

Broadening Questions of Religion and Delinquency:

Comparing Muslim, Christian, and Non-religious

Adolescents in the United Kingdom

Christopher Seto, The Pennsylvania State University (chs37@psu.edu)

Community and Identity: Observing A Developmental

Trajectory of Religious and Spiritual Struggle in Emerging Adults

Katheryn Kelley, University of Notre Dame (kkelley5@nd.edu)

CO-AUTHOR 1: Anne-Charlotte Belloeil, University of Notre Dame

CO-AUTHOR 2: Lucia Cho, University of Notre Dame

***Religious beliefs and risk-taking among
young adults experiencing homelessness***

Deidra Carroll Coleman, University of Texas Health Science Center at Houston, Cizik School of Nursing (deidra.c.coleman@uth.tmc.edu)

CO-AUTHOR 1: Diane Santa Maria, University of Texas

Health Science Center at Houston, Cizik School of Nursing

CO-AUTHOR 2: Sarah Narendorf, University of Houston

CO-AUTHOR 3: Robin Petering, University of Southern California

CO-AUTHOR 4: Kristin Ferguson, Arizona State University

CO-AUTHOR 5: Diane Santa Maria, University of Texas

Health Science Center at Houston, Cizik School of Nursing

CO-AUTHOR 6: Anamika Barman-Adhikari, University of Denver

CO-AUTHOR 7: Hsun-Ta Hsu, University of Missouri

CO-AUTHOR 8: Kimberly Bender, University of Denver

F-7 SSSR: AUTHOR MEETS CRITICS:

STUDYING LIVED RELIGION

► **Room: Executive Suite**

ORGANIZER/CONVENER: Orit Avishai, Fordham University (avishai@fordham.edu)

AUTHOR: Nancy Ammerman, Boston University (nta@bu.edu)

PARTICIPANTS

Kelsy Burke, University of Nebraska at Lincoln (kburke@unl.edu)

R. Marie Griffith, Washington University (mgriffith@wustl.edu)

John O'Brien, NYU Abu Dhabi (jho3@nyu.edu)

Tia Noelle Pratt, Villanova University (tia.pratt@villanova.edu)

Rachel Rinaldo, University of Colorado Boulder (rachel.rinaldo@colorado.edu)

F-8 SSSR: SPIRITUALITY AND RELIGION

IN INDIGENOUS SPACES

► **Room: Broadway II**

CONVENER: Andrew Chesnut, Virginia Commonwealth University (rachesnut@vcu.edu)

***"Evanglizing the Souls": An Empirical Study of Its Impact on
Social Identity and Spiritual Orientation of Indigenous Converts***

Chang-ho Ji, La Sierra University (cji@lasierra.edu)

CO-AUTHOR 1: Keith Drieberg, La Sierra University

CO-AUTHOR 2: Gidion Tambunan, La Sierra University

Syncretic Santa Muerte:

The Bricolage of a New Religious Movement

Andrew Chesnut, Virginia Commonwealth University (rachesnut@vcu.edu)

***Sacred Space/s and Environment Conservation among
the Sengwer People in Embobut Forest in Kenya.***

King'asia Mamati, University of Cologne (mamatikingasia@gmail.com)

***Indigenous Migrant Women from Bolivia in Mendoza: Multiple
Presences at the Intersections of Religion, Gender, and Ethnicity***

Ernesto Fiocchetto, Florida International University

([s\(ernesto.fiocchetto@gmail.com](mailto:s(ernesto.fiocchetto@gmail.com))

F-9 SSSR: RELIGIOUS LEADERS' GROWTH AND CHANGE

► **Room: Park Room**

CONVENER: Okeloh Ogera, (revokellohogera@gmail.com)

***Analyzing Replacement Theology: Evangelical Pastors'
Views on the Role of Jews and Israel in the End Times***

Motti Inbari, UNC Pembroke (inbari@uncp.edu)

CO-AUTHOR 1: Motti Inbari, UNC Pembroke

CO-AUTHOR 2: Kirill Bumin, UNC Pembroke

***The leadership crisis in Shia Islam
and occulting the non-existent imam***

Mansoor Moaddel, University of Maryland (moaddel@umd.edu)

CO-AUTHOR: Mansoor Moaddel, University of Maryland

***Traits of Religious Leadership: Moral Integrity and
Communal Involvement Outweigh Personal Meaning***

Michael Nielsen, Georgia Southern University (mnielsen@georgiasouthern.edu)

CO-AUTHOR: Alexander Raymond, Georgia Southern University

***Keep the Faith, Change the Church: Understanding the
Temporal and Spatial Growth of a Lay Catholic Movement***

Larissa Caldeira, University of Washington (caldeira@uw.edu)

SSSR
NETWORKING LUNCH

Saturday, October 23
12:15 PM – 1:10 PM

Skyline I and II

**TICKETED
EVENT**

MORMON SOCIAL SCIENCE ASSOCIATION MEETING

Saturday, October 23 | 12:15 PM – 1:10 PM | Broadway IV

SSSR PRESIDENTIAL PANEL

Pavilion Ballroom | Saturday, October 23, 1:10 PM – 2:10 PM

Challenging and Expanding Paradigms of the Scientific Study of Religion

ORGANIZER

Prema Ann Kurien
Syracuse University
(pkurien@syr.edu)

PANELISTS

Anna Sun | Duke University | (anna.x.sun@duke.edu)
*A Boundary Between the Things Misnamed:
Looking for Religion and Spirituality in Contemporary China*

Michael McNally | Carleton College | (mmcnally@carleton.edu)
*No One Word for Religion:
Native American Traditions, Sacred Places, and the Law*

Sandra Barnes | Vanderbilt University | (sandra.l.barnes@vanderbilt.edu)
The Black Church: Research, Relevance, and Reckoning

Melissa Guzman-Garcia | San Francisco State University | (mguz@sfsu.edu)
*American Evangelicalism and The Spirit of Carcerality:
Latinx Protestants Reclaiming Collective Spiritual Power from Carceral Control*

SATURDAY, OCTOBER 23

2:20PM - 3:50PM

PAPER SESSION G

G-1 SSSR: AUTHOR MEETS CRITICS: NONE OF THE ABOVE: NONRELIGIOUS IDENTITY IN THE U.S. AND CANADA

► Room: Cabinet Suite

ORGANIZER/CONVENER: Sarah Wilkins-Laflamme, University of Waterloo
(sarah.wilkins-laflamme@uwaterloo.ca)

AUTHOR: Joel Thiessen, Ambrose University (jathiessen@ambrose.edu)

CO-AUTHOR: Sarah Wilkins-Laflamme, University of Waterloo

PARTICIPANTS

Penny Edgell, University of Minnesota (edgell@umn.edu)

Christel Manning, Sacred Heart University (manningc@sacredheart.edu)

David Voas, University College London (d.voas@ucl.ac.uk)

G-2 SSSR: RELIGION, BLACK LIVES MATTER, AND RACIAL RECONCILIATION

► Room: Council Suite

CONVENER: Andrea Henderson, University Of South Carolina
(ahenderson@sc.edu)

Race, Religion, and Black Lives Matter

Khari Brown, Wayne State University (kharib@wayne.edu)

CO-AUTHOR: Khari Brown, Wayne State University

Towards a Social (Justice) Gospel:

The Prefigurative Politics of Black Christian Millennials

Shaonta' Allen, Dartmouth College (shaonta.allen@dartmouth.edu)

Race, Religion, & the Twentysomething Soul

Tim Clydesdale, The College of New Jersey (clydesda@tcnj.edu)

Diversity as Philanthropy:

Diversity Ideology among Associate Pastors of Color

Oneya Okuwobi, The Ohio State University (okuwobi.1@osu.edu)

G-3 SSSR: THEORIZING CHRISTIAN NATIONALISM AND WHITE SUPREMACY

► Room: Executive Suite

CONVENER: Mark Gould, Haverford College (mgould@haverford.edu)

L'etat Cest Moi: Pentecostal Charisma & Mystical Kingship

Erica Ramirez, Auburn Seminary (erica.ramirez@gmail.com)

CO-AUTHOR: João Chaves, PhD, Auburn Seminary

The Rhetoric of Christian Nationalism in White Supremacy Movements

Joseph Baker, East Tennessee State University (bakerjo@etsu.edu)

CO-AUTHOR: Samuel Stroope, Louisiana State University

One Nation, Under Fear:

Christian Nationalism and Fear in the United States

Andrew Whitehead, Indiana University-Purdue University Indianapolis

(aw122@iu.edu)

White Evangelical Emotion Work and Sustained Racial Inequality

Sarah Diefendorf, Intermountain Healthcare (sarah.diefendorf@imail.org)

G-4 RRA: CARA RECENT RESEARCH ON CATHOLIC CHURCH

► Room: Forum Suite

ORGANIZER/CONVENER: Thomas Gaunt, Center for Applied Research in the
Apostolate (tpg9@georgetown.edu)

Continuing to Fulfill the Charism and Mission of Catholic High Schools in Lesotho during a Time of a Declining Number of Religious Sisters

Aloysia Makoe, Center for Applied Research in the Apostolate
(samakoe@yahoo.co.uk)

Culture and Ethnicity in Vocations to Religious Life in the United States

Thu Do, Center for Applied Research in the Apostolate (ttd9@georgetown.edu)

Areas of Satisfaction and Challenge among Recently Ordained U.S. Catholic Priests

Jonathon Wiggins, Center for Applied Research in the Apostolate
(jlw8@georgetown.edu)

G-5 SSSR: INVESTIGATING WORLDVIEWS USING A TYPOLOGICAL PRISM

► Room: Broadway II

ORGANIZER: Ramona Bullik, Bielefeld University, Germany
(ramona.bullik@uni-bielefeld.de)

CONVENER: Ralph W. Hood, University of Tennessee at Chattanooga, USA
(ralph-hood@utc.edu)

Worldview Styles and Religious Styles. The Typological Contribution of a Structural-developmental Perspective

Heinz Streib, Bielefeld University, Germany (heinz.streib@uni-bielefeld.de)

CO-AUTHOR: Ralph W. Hood, University of Tennessee at Chattanooga, USA

Religious Development: Results from Longitudinal Data with Faith Development Interviews

Zhuo Job Chen, Clemson University, USA (zhuoc@clemson.edu)

CO-AUTHOR 1: Ralph W. Hood, University of Tennessee at Chattanooga, USA

CO-AUTHOR 2: Heinz Streib, Bielefeld University, Germany

Esoteric Worldviews. A Qualitative Analysis

Anika Steppacher, Bielefeld University, Germany
(anika.steppacher@uni-bielefeld.de)

CO-AUTHOR 1: Ramona Bullik, Bielefeld University, Germany

CO-AUTHOR 2: Barbara Keller, Bielefeld University, Germany

CO-AUTHOR 3: William Andrews, University of Tennessee at Chattanooga

SATURDAY, OCTOBER 23

2:20PM - 3:50PM

Examining the Development of Moral Worldview Beliefs Using Moral Foundations Theory

Zachary Swanson, University of Tennessee at Chattanooga, USA
(rbs972@mocs.utc.edu)

CO-AUTHOR 1: Matthew Durham, University of Tennessee at Chattanooga, USA
CO-AUTHOR 2: Ralph W. Hood, University of Tennessee at Chattanooga, USA

**G-6 RRA: FAITH COMMUNITIES TODAY #3
- 2020 DENOMINATIONAL RESULTS**

► **Room: Directors Suite**

ORGANIZER: Scott Thumma, Hartford Institute for Religion Research
(sthumma@hartsem.edu)

A 2020 Portrait of Church of the Nazarene Congregations

Rich Houseal, Research Services, director Church of the Nazarene Global Ministry Center (rhouseal@nazarene.org)

The Good, the Bad, and the Stoic: How Seventh-day Adventists Compare on Mission, Worship, and Programming

Petr Cincala, Director, Institute of Church Ministry, Andrews University
(cincala@andrews.edu)

A 2020 Portrait of Presbyterian Church, USA Congregations

Susan Barnett, Director, Research Services, Presbyterian Church, USA
(susan.barnett@pcusa.org)

G-7 SSSR: RELIGION, JUSTICE, AND THE ENVIRONMENT

► **Room: Broadway III**

CONVENER: Yaakov Ariel, University of North Carolina (yariel@email.unc.edu)

A Brazilian Representative of Religious-Inspired Anti-Environmentalism

Renan William dos Santos, University of São Paulo/Brazil and Drew University (renan_william.santos@hotmail.com)

Environmental and Ecological Justice in (Non)Religious Environmental Activism

Lauren Strumos, The University of Ottawa (lstru054@uottawa.ca)

Social Identity, Wildlife, Religion, and Dominance

Kwan-Lamar Blount-Hill, Borough of Manhattan Community College / Kings County District Attorney's Office (kblounthill@bmcc.cuny.edu)

G-8 SSSR: MODERNIZATION, MEGACHURCHES, AND THE URBAN FACE OF CHRISTIANITY IN THE GLOBAL SOUTH

► **Room: Park Room**

ORGANIZER/CONVENER: Timothy Wadkins, Canisius College
(wadkins@canisius.edu)

Comparative Survey Research on Megachurches in the Global South: What Do the Data Show?

Patricia Christian, Canisius College visiting (christia@canisius.edu)

The Spiritual and Social Capital of Pentecostal-Charismatic Megachurches in the Philippines

Joel Tejedo, Asia Pacific Theological Seminary, Baguio City, The Philippines
(joel_doulos@yahoo.com)

Victory, Prosperity, and Health at an Indian Megachurch in Lockdown

Chad Bauman, Butler University (cbauman@butler.edu)

Brazilian Megachurches and the Covid-19 Pandemic

Andrew Johnson, Metropolitan State University
(andrew.johnson@metrostate.edu)

G-9 SSSR: RELIGION AND EDUCATION

► **Room: Broadway I**

CONVENER: Thad Austin, (taustin@div.duke.edu)

School Climate, Attachment, and Future Church Affiliation

Josue Anguiano-Vega, La Sierra University (janguian@lasierra.edu)

Latinos, Faith and Science Education: How Congregational Participation Shapes the Science Education Outcomes of Latino Youth

Esmeralda Sánchez Salazar, Rice University (esmeralda.salazar@rice.edu)

Personal and Interpersonal Aspects of Religiosity: Comparing Christians, Hindus, Buddhists, and Muslims in Two Societies

Lauren Crane, Wittenberg University (lcrane@wittenberg.edu)

CO-AUTHOR 1: Shabana Bano, Banaras Hindu University

CO-AUTHOR 2: Ramesh C. Mishra, Banaras Hindu University

CO-AUTHOR 3: Sushma Pandey, D.D.U. Gorakhpur University

CO-AUTHOR 4: Nona Moskowitz, Wittenberg University

SATURDAY, OCTOBER 23

4:00PM - 5:30PM

PAPER SESSION H

H-1 SSSR: RELIGION, POLITICS, AND ATTITUDES TOWARDS THE "OTHER"

► Room: Forum Suite

CONVENER: Ines Jindra, Idaho State University (ineswengerjindra@isu.edu)

Who has Antipathy for Whom?: How Progressive and Conservative Protestants Rate Other Christians

George Yancey, Baylor University (george_yancey@baylor.edu)

To Hell with Tolerance: Salvific Exclusivity and Political Attitudes

Youssef Chouhoud, Christopher Newport University (youssef.chouhoud@cnu.edu)

Ex-Evangelicals as Moral Entrepreneurs in the Culture Wars

Richard Cimino, SUNY-Old Westbury (relwatch1@msn.com)

H-2 RRA: AMERICAN CHRISTIANITY AND SOCIAL PROBLEMS

► Room: Studio Suite

CONVENER: Dodeye Williams, Department of Political Science, University of Calabar (williamsdodeye@yahoo.com)

God's Resistance: Faith-based Advocacy for Immigrants During the Trump Administration

Brad Christerson, Biola University (bradley.christerson@biola.edu)

CO-AUTHOR 1: Robert Chao Romero, UCLA

CO-AUTHOR 2: Alexia Salvatierra, Fuller Theological Seminary

CO-AUTHOR 3: Nancy Wang Yuen, Biola University

Regional Religious Variation and Anti-Intellectualism

Jesse DeDeyne, Baylor University (jesse_dedeyne2@baylor.edu)

Still Divided by Faith?

Exploring Current Racial Attitudes among Evangelicals

Andrew Latour, The University of Texas at San Antonio (andylatour01@gmail.com)

CO-AUTHOR: Melinda Denton, The University of Texas at San Antonio

Churches and IPV

Amy Reynolds, Wheaton College (amy.reynolds@wheaton.edu)

CO-AUTHOR: Jenny Beth Cox, Wheaton College

H-3 SSSR: RELIGION, POPULISM, AFTER 45 (TRUMP)

► Room: Broadway IV

CONVENER: Nic Frame, Purdue University (nframe@purdue.edu)

God's President: Memes, CREDs, and Donald Trump

Thomas B Ellis, Appalachian State University (ellistb@appstate.edu)

American Religious Populism After the Trump Years

James Guth, Furman University (jim.guth@furman.edu)

CO-AUTHOR: Lyman Kellstedt, Wheaton College (IL) emeritus

Promoting populism in the spiritual supermarket: Conspirituality revisited

David Voas, University College London (d.voas@ucl.ac.uk)

The Church of Vladimir and Donald: Evangelicals, Politics, and the ROC

Andy Bunnell, University of Washington (abunnell@uw.edu)

H-4 RRA: THE U.S. RELIGION CENSUS: HISTORY, METHODS, AND USES

► Room: Council Suite

ORGANIZER: Clifford Grammich, Association of Statisticians of American Religious Bodies (usreligioncensus@gmail.com)

The U.S. Religion Census: A History

Clifford Grammich, Association of Statisticians of American Religious Bodies (usreligioncensus@gmail.com)

CO-AUTHOR: Rich Houseal, Nazarene Global Ministry Center

Orthodox Christianity in the American Religious Landscape: Preliminary Findings from the 2020 US Religion Census

Alexei Krindatch, National Census of Orthodox Churches / 2020 US Religion Census (akrindatch@aol.com)

Methods for Counting Catholics and Implications for the U.S. Religion Census

Clifford Grammich, Association of Statisticians of American Religious Bodies (usreligioncensus@gmail.com)

Enumerating Local Congregations: Comparing Denominational and Other Sources

Rich Houseal, Nazarene Global Ministry Center (rhouseal@nazarene.org)

H-5 SSSR: THE IMPACT OF THE COVID-19 PANDEMIC ON CONGREGATIONAL LEADERS

► Room: Skyline IV

ORGANIZER/CONVENER: David Eagle, Duke University (david.eagle@duke.edu)

Pandemic Impact on Church of the Nazarene Congregations and Pastors

Joel Thiessen, Ambrose University (jathiessen@ambrose.edu)

CO-AUTHOR: Rich Houseal, Church of the Nazarene Global Ministry Center

COVID-19 and Church Attendance among American Evangelical Congregations

Andrew MacDonald, Wheaton College, Billy Graham Center (andrew.macdonald@wheaton.edu)

SATURDAY, OCTOBER 23

4:00PM - 5:30PM

The Experiences of Pastors During the COVID-19 Pandemic: A Qualitative Study of Clergy across the Washington, D.C. Area

Timothy Snyder, Wesley Theological Seminary (tsnyder@wesleyseminary.edu)

Pastoral Ministry in Unsettled Times: A Qualitative Study of the Experiences of United Methodist Clergy during the COVID-19 Pandemic

Erin Johnston, Duke University (erin.johnston035@duke.edu)

CO-AUTHOR: David Eagle, Duke University

H-6 SSSR: SEXUALITY AND IDENTITY CONCERNS IN MORMONISM

► Room: Broadway III

ORGANIZER: Jana Riess, President, Mormon Social Science Association
(riess.jana@gmail.com)

CONVENER: Gordon Shephard, (gordons@uca.edu)

Four Domains Related to Single/Relationship Status among Sexual Minorities Raised Conservatively Religious

Tyler Lefevor, Utah State University (tyler.lefevor@usu.edu)

CO-AUTHOR 1: Ron L. Schow, Idaho State University

CO-AUTHOR 2: A. Lee Beckstead, private practice

"Just Let Us Love One Another": Social Media and the LGBTQ+ Student Struggle at Brigham Young University

Calvin Burke, Brigham Young University (burke.calvinj@gmail.com)

Sexual Behavior among Former Latter-day Saints

Jana Riess, Religion News Service (riess.jana@gmail.com)

H-7 SSSR: RELIGION AND HEALTH I

► Room: Executive Suite

CONVENER: Abimbola Adelakun, University of Texas, Austin
(adelakun@austin.utexas.edu)

Disability Advocacy and Ministry among Christians in Russia and Eastern Europe Since 1989

Albert Herzog, Retired Scholar (herzoga3@gmail.com)

Suicide Prevention in Japan by Collaborative Efforts between Mental Health Professionals and Buddhist Monks

Tatsushi Hirono, Austin Peay State University (hironot@apsu.edu)

Religion, Flow, and Happiness: Evidence from an Indigenous Religion in Asia

Chang-ho Ji, La Sierra University (cji@lasierra.edu)

CO-AUTHOR 1: Vy Cao, La Sierra University

CO-AUTHOR 2: Zixuan Zhao, La Sierra University

Pre-Post Mindfulness Changes in Affect Depend on the Interaction of Participant Religious Beliefs with the Religious Framings of Mindfulness Guidance

Micheline Anderson, Department of Psychiatry and Human Behavior,
Warren Alpert Medical School at Brown University
(micheline_anderson@brown.edu)

CO-AUTHOR 1: Roman Palitsky, Department of Psychiatry and Human Behavior,
Warren Alpert Medical School at Brown University

CO-AUTHOR 2: Deanna Kaplan, Department of Behavioral and
Social Sciences, Department of Psychiatry and Human Behavior,
Warren Alpert Medical School at Brown University

H-8 SSSR: PARISH RESEARCH 2

► Room: Broadway II

ORGANIZER/CONVENER: Pierre Hegy, Adelphi University (pierre.hegy@gmail.com)

A case study of a Benedictine Monastery: Structure, Individual Agents and Institutional Breakdown

Paul Kasun, Universidad del Rosario, Colombia (frpaul@utexas.edu)

Types of Religious District in an Urban Area

Anthony J. Blasi, Retired, San Antonio, Texas (j6anthonyblasi@yahoo.com)

Catholic Experiences of Parish Life and Church Leadership

Maureen K. Day, Franciscan School of Theology (maureen.day@fst.edu)

CO-AUTHOR: Michele Dillon, University of New Hampshire

Sacraments without the Sacerdote:

The Changing Role of Laity in Rural Ecuadorian Catholicism

Jill DeTemple, Southern Methodist University (detemple@mail.smu.edu)

H-9 SSSR: AUTHOR MEETS CRITICS: AGENTS OF GOD: BOUNDARIES & AUTHORITY IN MUSLIM & CHRISTIAN SCHOOLS

► Room: Park Room

ORGANIZER/CONVENER: Daniel Winchester, Purdue University
(dwinches@purdue.edu)

AUTHOR: Jeffrey Guhin, UCLA (guhin@soc.ucla.edu)

PARTICIPANTS

Amy McDowell, University of Mississippi (mcdowell@olemiss.edu)

John O'Brien, NYU Abu Dhabi (jho3@nyu.edu)

C.J. Pascoe, University of Oregon (cpascoe@uoregon.edu)

Rhys Williams, Loyola University Chicago (rwilliams7@luc.edu)

H-10 SSSR: EXPLORING THE PANDEMIC IMPACT ON U.S. CONGREGATIONS: INITIAL FINDINGS AND INSIGHTS FROM THE RESEARCH JOURNEY

► Room: Directors Suite

ORGANIZER: Allison Norton, Hartford Seminary (anorton@hartsem.edu)

Pandemic Past, Pandemic Present: Comparing Congregational Responses to The Spanish Flu and Coronavirus

Andrew Gardner, Hartford Seminary (agardner@hartsem.edu)

SATURDAY, OCTOBER 23

4:00PM - 5:30PM

The Present and Future of the Pandemic Project

Scott Thumma, Hartford Institute for Religion Research
(sthumma@hartsem.edu)

Embarking on Large-Scale Congregational Research:

Methodological and Practical Considerations

Allison Norton, Hartford Seminary (anorton@hartsem.edu)

Understanding Pre- and Post-Shutdown Congregational Change:

Initial Findings and Observations

Patricia Tevington, Hartford Institute for Religion Research
(ptevington@hartsem.edu)

**H-11 SSSR: SCIENCE AND (UN)RELIGIOSITY IN MEDITATION
AND MINDFULNESS**

► **Room: Broadway I**

ORGANIZER: Roman Palitsky, Brown University (roman_palitsky@brown.edu)

***Dynamics of Science and Religiosity in the Context of
Meditation-Related Challenges: Processes of Meaning-Making
among Practitioners of Buddhist Meditation in the West***

Roman Palitsky, Brown University (roman_palitsky@brown.edu)

CO-AUTHOR 1: Jared Lindahl, Brown University

CO-AUTHOR 2: David Cooper, Brown University

***The Perceived (In)Compatibility of
Christianity with Mindfulness Meditation***

Candy Brown, Indiana University (browncg@indiana.edu)

Atheists on the Cushion:

Is Mindfulness a Religion Tailored to the Nonreligious?

Masoumeh Sara Rahmani, Victoria University of Wellington (NZ)
(masoumeh.sara.rahmani@gmail.com)

CO-AUTHOR 1: Miguel Farias, Coventry University (UK)

CO-AUTHOR 2: Valerie van Mulukom, Coventry University (UK)

H-12 SSSR: RELIGION AND GENDER VIOLENCE

► **Room: Cabinet Suite**

CONVENER: Amanda Hernandez, Baylor University
(amanda_hernandez4@baylor.edu)

***Gender, Genocide and the Transmission
of Trauma Across Generations***

Janet Jacobs, University of Colorado (jacobsjl@colorado.edu)

The Space Between: Purity Culture as a Liminal Time

Tessi Rickabaugh, University of Missouri, Columbia
(rickabaught@missouri.edu)

***Self-Control, Intimate Partner Violence, and Divine Control: Does
Greater Belief in Divine Control Moderate the Adverse Effects of
Low Self-Control on Intimate Partner Violence in Thailand?***

Colton Daniels, University of Texas at San Antonio (colton.daniels@utsa.edu)

***Rituals, Routines and Religion: Understanding the Experiences
of Brothel-Based Sex Workers in New Delhi, India***

Popy Begum, Rutgers University-Newark (popy.begum@rutgers.edu)

SSSR AWARDS AND PRESIDENTIAL ADDRESS

SATURDAY, OCTOBER 23, 5:45 PM – 7:00 PM
Pavilion Ballroom

*Religion as Social Location:
Global and Comparative
Perspectives*

PREMA ANN KURIEN
Syracuse University | (pkurien@syr.edu)

SSSR PRESIDENTIAL RECEPTION

FOLLOWING THE PRESIDENTIAL ADDRESS

7:00 PM – 9:00 PM
Plaza Foyer

SUNDAY

OCTOBER 24

7:30 am – 9:00 am	Morning Coffee, Sponsored by RRA	Plaza Foyer
8:30 am – 10:00 am	Registration	Plaza Foyer
9:00 am – 10:30 am	Paper Session I	
10:40 am – 12:00 pm	Paper Session J	

SUNDAY, OCTOBER 24

9:00AM - 10:30AM

PAPER SESSION I

I-1 SSSR: RELIGION AND GENDER II

► Room: Broadway II

CONVENER: Candice Bentley-Held, (bentley.cand@gmail.com)

Gender Gaps and Risky Religion: The Impact of Societal Discrimination and Government Religious Restrictions on the Gender Gap in Religiosity

Dane Mataic, North Dakota State University (dane.mataic@ndsu.edu)

CO-AUTHOR: Kerby Goff, The Pennsylvania State University

Mattering to God and to the Congregation: Gendered Effects in Mattering as a Mechanism between Religiosity and Mental Health

Laura Upenieks, Baylor University, Department of Sociology (laura_upenieks@baylor.edu)

CO-AUTHOR: Rebecca Bonhag, Baylor University, Department of Sociology

Who Wears the Hijab? Predictors of Veiling in the United States

Eman Abdelhadi, University of Chicago (abdelhadi@uchicago.edu)

Trends in Traditional Identities: The Cross-Lagged Predictive Power of Gender Ideology and Religiosity

Elizabeth McElroy, University of Oklahoma (elizabeth.mcelroy@ou.edu)

CO-AUTHOR 1: Abby Young (s.abby.young@ou.edu)

CO-AUTHOR 2: Cyrus Schleifer (cyrus.schleifer@ou.edu)

I-2 SSSR: FAITH-BASED ORGANIZATIONS - RELIGION AS STATE ACTORS

► Room: Broadway I

CONVENER: Manuel Padro, Independent researcher (MPadro23@gmail.com)

International and Domestic Sources of Religious Movements: Korean Missionaries in High-risk Countries

Jihye Jung, Arizona State University (jjung60@asu.edu)

Faith Actors and Refugee Policy: Strategies to Influence UNHCR

Ernesto Fiocchetto, Florida International University

(ernesto.fiocchetto@gmail.com)

Gender in International Christian Organizations: A Review of Leadership, Organizational Realities, and Programming

Amy Reynolds, Wheaton College (amy.reynolds@wheaton.edu)

Religious Protection from Populist Violence:

The Catholic Church and the Philippine Drug War

David Buckley, University of Louisville (david.buckley@louisville.edu)

CO-AUTHOR 1: Steven Brooke, University of Wisconsin - Madison

CO-AUTHOR 2: Ron Mendoza, Ateneo de Manila University

I-3 SSSR+RRA: INTERDISCIPLINARITY OF HISTORY & SOCIAL SCIENCES

► Room: Council Suite

CONVENER: Michelle Ramirez, University of the Sciences (m.ramirez@uscience.edu)

"The Lord Will Make a Way Somehow": Black Sacred Music and the Battle for the Soul of American Civil Religion

Hassaun Jones-Bey, California State University East Bay (hjonesbey@horizon.csueastbay.edu)

Stronger Together: the Durability of Racial-Minority Religious Congregations in Manhattan, 1949-1999

Casey Homan, University of California, Berkeley (caseyhoman@berkeley.edu)

Oppressed Minorities and Protected Minorities: The Comparative Study of the Croats and the Jewish in Bosnia and Herzegovina

Yukie Tatta, The University of Tokyo (tattayukie@gmail.com)

I-4 SSSR: EMOTION, COGNITION, AND EXPERIENCING RELIGION

► Room: Broadway III

CONVENER: Tyler Lefevor, (tyler.lefevor@usu.edu)

SUNDAY, OCTOBER 24

9:00AM - 10:30AM

***Religious intuitions, theory of mind,
and supernatural experience***

Laird Edman, Northwestern College (ledman@nwciowa.edu)

CO-AUTHOR 1: Hannah Paauw, Northwestern College

CO-AUTHOR 2: Taelor Lamansky, Northwestern College

Feeling Close to the Divine:

Situating Sacred Awareness using Participant Photo Elicitation

Rory Jones, Baylor University (rory_jones@baylor.edu)

You Have to Feel It to Know It: How Objectification

Integrates Practical and Discursive Consciousness

Spencer Paine, UC Irvine (spaine@uci.edu)

I-5 SSSR: RELIGIOUS ORIENTATIONS

► **Room: Broadway IV**

CONVENER: Jana Riess, Religion News Service (riess.jana@gmail.com)

Soteriology, Eschatology and Theodicy:

Value-commitments in Christianity, Islam and Judaism

Mark Gould, Haverford College (mgould@haverford.edu)

Spiritual Technology of the Secular:

The Meditation of Marcus Aurelius

Kyle Smith, Rice University (2kylesmith@gmail.com)

CO-AUTHOR: Chris Senn, Rice University

***The Discussion of Religion and Spirituality in Sociology
and Social Work: Similarities and Differences***

Ines W. Jindra, Idaho State University (ineswengerjindra@isu.edu)

SUNDAY, OCTOBER 24

10:40AM - 12:10PM

PAPER SESSION J

J-1 SSSR: EDUCATION AND TEACHING IN RELIGION

► Room: Broadway I

CONVENER: Christopher Suehr, Catholic University (Cjsuehr@gmail.com)

Teaching Brave: Dialogic Strategies for Religious Studies Classrooms

Jill DeTemple, Southern Methodist University (detemple@mail.smu.edu)

Narratives of Secularization in Western Civilization Textbooks

Kevin Flatt, Redeemer University (kflatt@redeemer.ca)

CO-AUTHOR 1: Kevin Flatt, Redeemer University

CO-AUTHOR 2: Johanna Lewis, Cardus

Characteristics of Courses in the Psychology of Religion

Michael Nielsen, Georgia Southern University (mnielsen@georgiasouthern.edu)

CO-AUTHOR: Veronica O'Brien, Georgia Southern University

J-2 SSSR: RELIGION AND HEALTH II

► Room: Broadway III

CONVENER: Eugene Clay, Arizona State University (clay@asu.edu)

Age and Religiosity among Jews in America and Israel

Nadia Beider, Hebrew University (nadia.beider@mail.huji.ac.il)

Attitudes Towards Abortion:

Does Belief in God Matter for the Non-Religious?

Nic Frame, Purdue University (nframe@purdue.edu)

Religion and Infertility

Gabriel Lotarski, Wayne State University (gb7861@wayne.edu)

J-3 SSSR: RELIGION AND INEQUALITIES

► Room: Broadway II

CONVENER: Stephen Glazier, Yale University (stephen.glazier@yale.edu)

Ethnic Inequalities and the Muslim Penalty:

Labour Market Dynamics of Ethno-Religious Groups in Britain

Samir Sweida-Metwally, University of Bristol

(samir.sweida-metwally@bristol.ac.uk)

The Religious Roots of Economic and Social Individualism:

A Global Perspective on Weberian Theory

Sabri Ciftci, Kansas State University (ciftci@ksu.edu)

Pentecocapitalism and Neoliberal Subjectivity:

A South African Case Study

Bradley Johnson, Rice University (bmj3@rice.edu)

Mormons and Mining: A Historical Case Study on Money, Moral Institutions, and Moral Hazard

Christopher Smith, John Whitmer Books (chrisrollsmith@gmail.com)

5J-4 SSSR: RELIGION AND YOUTH II

► Room: Broadway IV

Convener: Erin Johnston, (erin.johnston035@duke.edu)

Blessings and Bistros: Overcoming a "Paralyzed Heart"

Annette Mackay, West Virginia University (amm0065@mix.wvu.edu)

Youth religiousness, parent-child relations, and substance use problems

John Hoffmann, BYU (john_hoffmann@byu.edu)

Apocalypse Kids: Esoteric Childhoods in New Religions Movements: Symbolism, Conflict and Ownership

Susan Palmer, McGill University (susan.palmer@mcgill.ca)

J-5 RRA: AUTHOR MEETS CRITICS: POLISH CATHOLICISM BETWEEN TRADITION AND MIGRATION AGENCY, REFLEXIVITY AND TRANSCENDENCE

► Room: Council Suite

ORGANIZER/CONVENER: Wojciech Sadlon, Institute for Catholic Church Statistics, Cardinal Stefan Wyszyński University (w.sadlon@iskk.pl)

AUTHOR: Wojciech Sadlon, Institute for Catholic Church Statistics, Cardinal Stefan Wyszyński University (w.sadlon@iskk.pl)

PARTICIPANTS

Tricia Bruce, University of Notre Dame (tbruce@nd.edu)

Roberta Riccucci, University of Turin (roberta.riccucci@unito.it)

Mary Gautier, CARA at Georgetown University (gautierm@georgetown.edu)

Jörg Stolz, University of Lausanne (joerg.stolz@unil.ch)

Roberto Cipriani, Roma Tre University (roberto.cipriani@tlc.uniroma3.it)



SOCIETY FOR THE SCIENTIFIC STUDY OF RELIGION CALL FOR PAPERS
2022 Annual Meeting | November 11-13, 2022 | Renaissance Baltimore Harbor Place Hotel, Maryland

Religion, Racial Unrest and Pandemics

As of Sept. 25, 2021, the global coronavirus pandemic has killed 700,000 Americans and over 4.5 million worldwide. In doing so, the pandemic contributed to a worldwide recession. Racial-group membership determines whom is most at risk to exposure and dying from COVID. In the USA and globally, concerns about surviving the pandemic coincides with increased awareness and worry about the police's disproportionate use of lethal force against citizens of African descent in countries such as the United States, Columbia, France, and Great Britain.

A deep concern for the public health and the safety of socially vulnerable people is leading religious leaders and laity to participate in social forums, protest marches, and contacting elected officials that places a high priority on the social welfare, health, and safety of communities. There is evidence of increased online Zoom congregational meetings about racial tolerance, friendships across racial and ethnic lines, as well what must be done to eradicate racialized policing and surveillance. Moreover, multinational entities such as the United Nations, Target, General Motors, and the World Council of Churches, the U.S. Department of State are publicly avowing to support anti-racism policies.

That said, we encourage proposals that examine the role that religion plays in the position that individuals and groups take on these and other quality of life issues in the USA and globally. We also encourage proposals that examine the degree to which religion influence individual and collective behaviors in response to said issues. We are particularly interested in how race, class, citizenship, and nationality determine the saliency of religion to how individuals think and respond to the pandemic, anti-Black police violence, and other quality of life issues. We, of course, welcome proposals on any topic on the scientific study of religion.

Submissions Open: February 15, 2022

Submissions Close: April 15, 2022

Decision Notification: May 15, 2022

Please submit proposals for individual papers, full panels, author-meets-critics sessions, and roundtables via the online portal at www.sssreligion.org, choosing the SSSR option on the submission form.

Please direct all inquiries to the SSSR 2022 Program Chairs Paul Djupe (*Dennison University*) and Amy Erica Smith (*Iowa State University*) at program@sssreligion.org.

THANK YOU

Our sincere thanks goes to . . .

The **Religious Research Association** for sponsoring coffee each morning.

Andrea Henderson and **Aida Ramos** for serving as the SSSR Program Co-Chairs, organizing not one, but two, conferences under less than ideal circumstances.

Gina Zurlo for serving as the RRA Program Chair and partner with Andrea and Aida on this year's program journey.

Ivy Raines for serving as the graduate student ambassador and **Joshua Groves**, who assisted with these efforts.

All of our session conveners, who kept everyone on time.

Harve Horowitz and **Kelly Marshall** from Exhibit Promotion Plus, who coordinated our book exhibit and annual meeting site selection.

Joshua Roberts, **Micah Gaeta** and the entire team from the Portland Hilton Downtown for their professionalism and support during the annual meeting.

INDEX

A

Abdelhadi, Eman: I-1
Adelakun, Abimbola: A-3, H-7
Adler, Gary: B-11
Adogame, Afe: B-9
Ahmad, Salman: C-3
Albanese, Anthony: B-7
Allen, Daniel: B-4, D-6
Allen, Shaonta': E-4, G-2
Alper, Becka A.: F-5
Ammerman, Nancy: F-7
Anderson, Cory: A-7
Anderson, Jennifer: A-7
Anderson, Micheline: H-7
Andrews, William: G-5
Andriot, Angie: C-2
Anguiano-Vega, Josue: G-9
Anwar, Kaina: B-12
Apaah, Felicity: B-9
Aponte, Edwin: B-8, C-4
Ariel, Yaakov: D-7, G-7
Armaly, Miles: E-7
Arsenault, Ken: E-8
Austin, Thad: F-1, G-9
Avishai, Orit: F-7

B

Bacon, Rachel: A-12
Bailey, Karl: A-6, B-1
Baker, Joseph: G-3
Bano, Shabana: C-3, G-9
Barman-Adhikari, Anamika: F-6
Barnes, Sandra: SSSR Presidential Panel
Barnett, Susan: D-7, G-6
Bartkowski, John: C-1
Baugh, Amanda: D-4
Bauman, Chad: G-8
Beckstead, A. Lee: H-6
Begum, Popy: H-12
Beider, Nadia: J-2
Beloeil, Anne-Charlotte: F-6
Bender, Kimberly: F-6
Bennett, Daniel: D-6
Bentley-Held, Candice: I-1
Berrelleza, Erick: A-9, B-3, C-3
Berry, Damon: A-11, C-6
Berry, Evan: D-4
Biolcati Rinaldi, Ferruccio: C-5
Bird, Warren: F-2
Blankhom, Joseph: C-5
Blasi, Anthony J.: H-8
Blount-Hill, Kwan-Lamar: G-7

Bok, Jared: C-3, F-3
Bonhag, Rebecca: I-1
Boucher, Guillaume: D-9
Brenchley, Kalina: D-6
Brenneman, Robert: D-8
Brooke, Steven: I-2
Brown, Brandon: B-4, E-3
Brown, Candy: D-5, H-11
Brown, Khari: G-2
Brown, Maria: C-5
Bruce, Tricia: C-1, D-8, J-5
Buckley, David: E-7, I-2
Bullik, Ramona: G-5
Bumin, Kirill: F-9
Bunnell, Andy: B-7, H-3
Burge, Ryan: A-9
Burke, Calvin: H-6
Burke, Kelsy: F-7
Burt, Jason: B-4

C

Caldeira, Larissa: F-9
Calvillo, Jonathan: B-3, C-1, E-1
Cantori, Valentina: C-6
Cao, Vy: H-7
Carnevale, Davide N.: B-7
Carriero, Renzo: C-5
Chan, Esther: D-6, E-7
Chaves, Mark: B-2
Chaves, João: G-3
Chen, Zhuo Job: A-9, E-2, G-5
Chesnut, Andrew: F-8
Cho, Lucia: F-6
Choi, Jeyoul: B-12
Chouhoud, Youssef: E-1, H-1
Christerson, Brad: H-2
Christian, Patricia: G-8
Ciftci, Sabri: E-8, J-3
Cimino, Richard: D-3, H-1
Cincala, Petr: B-1, G-5
Cipriani, Roberto: J-5
Clay, J. Eugene: D-7, J-2
Cline, Victoria: E-2
Clydesdale, Tim: G-2
Coe, Deborah: C-2
Coleman, Deidra Carroll: F-6
Collaborative Inquiry Team, Collaborative: D-2
Collett, Jessica: A-8
Colyer, Corey: E-5
Comeau, Katie: F-1
Cooley, Chelsea: B-11
Cooper, David: H-11
Cooperman, Alan: F-5

Corcoran, Katie: A-8, B-6, E-5
Cox, Jenny Beth: H-2
Cragun, Ryan: C-7, E-9
Crane, Lauren: C-3, F-6, G-9
Cummins, Alyshea: D-9

D

Dacey, Timothy: A-7
Daniels, Colton: H-12
Davidson, Kimberly: D-1
Day, Katie: E-4
Day, Maureen K.: H-8
DeDeyne, Jesse: H-2
Delaney, Dan: F-1
Denton, Melinda: C-8, H-2
DeTemple, Jill: H-8, J-1
Dhali, Helal Hossain: E-4
Di, Di: A-3
Diefendorf, Sarah: G-3
DiGregorio, Bernard: E-5
Dillon, Frank: B-12
Dillon, Michele: H-8
Djupe, Paul: A-9, C-8
Do, Thu: G-4
Dollahite, David: A-12
Dollhopf, Erica: A-4
dos Santos, Renan William: G-7
Dougherty, Kevin: B-4
Draper, Scott: A-8, E-3
Drieberg, Keith: F-8
Drumm, René: A-7, B-1
Duntley, Madeline: F-1
Durham, Matthew: E-1, G-5

E

Eagle, David: A-2, B-2, H-5
Ecklund, Elaine: A-5, F-3
Edgell, Penny: A-9, G-1
Edman, Laird: I-4
Ellis, Thomas B.: H-3
Ellison, Christopher G.: C-2
Enders, Adam: E-7
Evans, Hannah: B-4

F

Farias, Miguel: H-11
Ferguson, Kristin: F-6
Ferguson, Todd: F-1
Fiocchetto, Ernesto: F-8, I-2
Flannelly, Kevin J.: C-2
Flannelly, Laura T.: C-2
Flatt, Kevin: J-1
Flory, Richard: B-10

INDEX

Folk, Holly: A-11, E-6
Frame, Nic: H-3, J-2
Franklin, Andrew: A-1
Froese, Paul: A-8
Frost, Jacqui: A-9, C-7, D-2
Futris, Ted: A-12

G

Gaghan, Josh: A-2
Gallagher, Sally: D-8
Gardner, Andrew: H-10
Gärtner, Christel: D-9
Gaunt, Thomas: G-4
Gautier, Mary: A-4, F-3, J-5
Glazier, Stephen: J-3
Goff, Kerby: B-11, F-3, I-1
Gould, Mark: G-3, I-5
Grammich, Clifford: H-4
Gray, Mark: B-5
Griffith, R. Marie: F-7
Guhin, Jeffrey: A-2, H-9
Guth, James: H-3
Guthrie, Sara: E-5
Guzman, Melissa: B-3,
SSSR Presidential Panel

H

Haberman, David: D-4
Hannan, David: E-8
Hassan, Farooq: D-3
Hegy, Pierre: E-3, H-8
Henderson, Andrea: G-2
Hendricks, Justin: A-12
Hennig, Linda: D-9
Hernandez, Amanda: B-5, H-12
Herzog, Albert: H-7
Hirono, Tatsushi: A-3, H-7
Hoffmann, John: J-4
Holcombe, Jenny: D-6
Holleman, Anna: B-2
Hollinger, Franz: D-5
Holtmann, Catherine: A-12
Homan, Casey: I-3
Hood, Ralph W.: G-5
House-Niamke, Stephanie: B-6
Houseal, Rich: A-4, G-6, H-4, H-5
Houtman, Dick: D-5
Hsu, Becky: A-6, E-2
Hsu, Hsun-Ta: F-6

I

Iannaccone, Laurence: B-7
Inbari, Motti: F-9

J

Jackson, Mark: D-1
Jacobs, Janet: H-12
Jeong, Elijah: D-6
Ji, Chang-ho: F-8, H-7
Jindra, Ines: H-1, I-5
Johnson, Andrew: G-8
Johnson, Bradley: J-3
Johnston, Erin: A-2, H-5, J-4
Jones, Rory: B-4, D-8, I-4
Jones-Bey, Hassaun: I-3
Jung, Jihye: I-2

K

Kalinowski, Brenton: A-5
Kallatsa, Laura: B-12, D-9
Kaplan, Deanna: A-6, H-7
Kasun, Paul: H-8
Kaur, Navkiran: C-3, D-2
Keller, Barbara: G-5
Kelley, Kathryn: F-6
Kellstedt, Lyman: H-3
Kelman, Ari: A-2
Keysar, Ariela: F-5
King, W.: A-5
Knowlton, David: A-10
Kostarelos, Frances: A-5, C-7
Kotler-Berkowitz, Laurence: F-5
Krindatch, Alexei: F-2, H-4
Kucinskis, Jaime: E-8
Kurien, Prema Ann:
SSSR Awards & Presidential Address,
SSSR Presidential Panel

L

Lamansky, Taelor: I-4
Lang, Daniel Lindbergh: C-6
Lassiter, Jonathan Mathias: B-12
Latour, Andrew: H-2
Lefevor, Tyler: B-12, H-6, I-4
Lewis, Johanna: J-1
Lindahl, Jared: H-11
Lipps, Oliver: A-12
Lizardy-Hajbi, Kristina: C-4, D-2
Lopes, Jarrod: E-6
Loskota, Brie: B-10
Lotarski, Gabriel: J-2
Lu, Joseline: E-2

M

Mabute-Louie, Bianca: D-3
Macaluso, Suzanne: B-6

MacDonald, Andrew: H-5
MacGregor, Carol Ann: A-2
Mackay, Annette: J-4
MacMillen, Sarah: E-7
Majumder, Shantanu: A-1
Makoe, Aloysia: G-4
Mamati, King'asia: F-8
Manning, Christel: G-1
Marks, Loren: A-12
Marti, Gerardo: A-8, B-8, C-1, D-7
Martin, Wendy: B-12, D-2, E-2
Martinez, Brandon: E-1, F-1
Mataic, Dane: I-1
McBride, Duane: B-1
McCarthy, Angela: B-5
McClure, Jennifer: B-6
McClure, Paul: A-3
McDaniel, Eric: D-3
McDowell, Amy: C-8, H-9
McElroy, Elizabeth: I-1
McKinney, Jennifer: B-5
McLaughlin, Merranda: C-3
McMullen, Mike: F-2
McMullin, Steve: A-3
McNally, Michael: SSSR Presidential Panel
Melton, J. Gordon: A-11, E-6
Mendoza, Ron: I-2
Miles, Carrie: B-11, C-5
Miller, Brian: C-1, D-8
Miller, J.P.: A-7
Miller, Mahala: A-9
Milstein, Glen: F-1
Mishra, Ramesh C.: G-9
Moaddel, Mansoor: F-9
Mohamed, Besheer: E-1
Monnot, Christophe: B-6, B-7, C-7
Moskowitz, Nona: G-9
Moura, Mauricio: D-4
Mukherjee, Chirasree: E-4
Mulder, Mark: C-1, D-7
Murphy, Thomas W: A-10

N

Narendorf, Sarah: F-6
Nielsen, Michael: F-9, J-1
Norton, Allison: B-9, H-10
Noureldin, Laila: D-1

O

O'Brien, John: F-7, H-9
O'Brien, Veronica: J-1
Offutt, Steve: B-11
Ogera, E. Okelloh: B-9

INDEX

Ogera, Okelloh: A-5, F-9
Ogunnowo, Olaanike: B-9
Okuwobi, Oneya: G-2

P

Paauw, Hannah: I-4
Padro, Manuel: F-4, I-2
Paine, Spencer: I-4
Palitsky, Roman: A-6, H-7
Palmer, Jason: A-10
Palmer, Susan: J-4
Palomo, Johannah: B-5
Pandey, Sushma: G-9
Park, Jerry: B-3
Parmer, Daniel: D-3
Parsitau, Damaris: B-9
Pasca, Christina: C-7
Pascoe, C.J.: H-9
Patel, Chetna: A-9
Pearce, Lisa: B-5 C-8
Petering, Robin: F-6
Phillips, Bruce: B-10
Phillips, Nichole R.: RRA H. Paul Douglass
Lecture
Phillips, Richard E.: D-2
Phillips, Rick: F-4
Pieper, Christopher: A-3
Pizor Yoder, Susan: D-2
Pratt, Tia Noelle: F-7
Prickett, Pamela: A-6

R

Rahmani, Masoumeh Sara: H-11
Ramirez, Erica: B-3, G-3
Ramirez, Michelle: A-6, I-3
Ramos, Aida: B-3, D-6
Raymond, Alexander: F-9
Rebhun, Uzi: A-1
Reynolds, Amy: H-2, I-2
Ricci, Roberta: J-5
Richardson, James: E-7
Rickabaugh, Tessi: H-12
Ricucci, Roberta: C-5, J-5
Riess, Jana: A-10, F-4, H-6, I-5
Rinaldo, Rachel: F-7
Romero, Robert Chao: H-2
Roso, Joseph: B-2
Rosta, Gergely: C-5
Royle, Marjorie: D-2
Rush, Timothy: E-7
Ryan, Michael: B-4

S

Sadlon, Wojciech: D-7, J-5
Said, Iman: D-1
Salazar, Esmeralda Sánchez: G-9
Salvatierra, Alexia: H-2
Sands, Levi: F-4
Santa Maria, Diane: F-6
Saxe, Leonard: D-3, F-5
Schade, Leah: E-4
Schiffbeck, Adrian: A-5
Schleifer, Cyrus: I-1
Schneider, Rachel: A-5
Schow, Ron L.: H-6
Senn, Chris: I-5
Senn, Jeremy: B-6
Seto, Christopher: F-6
Shamaileh, Ammar: E-8
Sheikh, Christine: C-4
Shelton, Jason: C-8
Shepherd, Gary: A-10
Shepherd, Gordon: H-6
Sherman, Jennifer: B-5
Silverstein, Merrill: C-5, D-9
Skidmore, Samuel: B-12
Smith, Amy: A-12, D-4
Smith, Christopher: J-3
Smith, Jesse: E-9
Smith, Kyle: I-5
Snyder, Timothy: H-5
Spännäri, Jenni: D-9
Stanford, William D.: A-12
Starr, Chelsea: A-1, E-2
Stein, Rachel: E-5
Steppacher, Anika: G-5
Stewart, Evan: A-7, E-8
Stockly, Kate J.: A-8
Stolz, Jörg: A-12, B-6, J-5
Strehlow, Sean: B-4
Streib, Heinz: G-5
Stroope, Samuel: G-3
Strumos, Lauren: G-7
Suehr, Christopher: A-9, J-1
Sullivan, Daniel: A-6
Sun, Anna: SSSR Presidential Panel
Swanson, Zachary: G-5
Sweida-Metwally, Samir: J-3
Szvetelszky, Zsuzsanna: C-5

T

Tambunan, Gidion: F-8
Tatta, Yukie: I-3
Tejedo, Joel: G-8

Tervo-Niemelä, Kati: C-2, D-9
Tevington, Patricia: E-8, H-10
Thiessen, Joel: E-9, G-1, H-5
Thompson, Jennifer: B-10
Thomson, Robert: D-1
Thumma, Scott: A-4, C-4, F-2, G-6, H-10
Timmermans, Stefan: A-6
Tokke, Hans: D-3
Tom, Joshua: E-1
Trecartin, Shannon: B-1
Trim, David: B-1
Tromp, Paul: D-5
Tumminia, Diana: A-11

U

Upenieks, Laura: I-1

V

van Mulukom, Valerie: H-11
Vegter, Abigail: E-4
Villanueva, Randle: A-9, E-2
Voas, David: A-12, E-9, G-1, H-3

W

Wadkins, Timothy: G-8
Watts, Galen: D-5
Weisman de Mamani, Amy: C-3
Wellman, James K.: A-8, E-3
Wernli, Boris: B-7
Whitehead, Andrew: G-3
Wiggins, Jonathon: A-4, G-4
Wilkins-Laflamme, Sarah: G-1
Williams, Dodeye: B-9, H-2
Williams, Rhys: C-6, H-9
Winchester, Daniel: H-9
Wittberg, Patricia: F-3
Wollschleger, Jason: A-8, E-3
Wright, Stuart: A-11
Wuthrich, Michael: E-8

Y

Yancey, George: C-2, H-1
Yao, Jia: F-1
Young, Abby: I-1
Yuen, Nancy Wang: H-2

Z

Zhao, Zixuan: H-7
Ziccardi, Debora: D-4
Zuckerman, Phil: E-9
Zurlo, Gina: E-8

PAST PRESIDENTS

PRESIDENTS OF SSSR

1949 Walter H. Clark
1952 Talcott Parsons
1954 Prentiss Pemberton
1956 Richard V. McCann
1958 James Luther Adams
1960 Horace Kallen
1962 Horace L. Friess
1964 Walter H. Clark
1966 Peter L. Berger
1968 Charles Y. Glock
1970 Joseph H. Fichter
1974 Paul W. Pruyser
1976 Allan W. Eister
1978 William V. D'Antonio
1980 Benton Johnson
1982 Marie Augusta Neal
1984 Jeffrey K. Hadden
1986 Phillip E. Hammond
1988 Meredith McGuire
1990 Donald Capps
1992 Eileen Barker
1994 Ruth Wallace
1996 Wade Clark Roof
1998 Jay Demerath
2000 Helen Rose Ebaugh
2002 Robert Wuthnow
2003 Rodney Stark
2004 Nancy Ammerman
2005 Donald Miller
2006 R. Stephen Warner
2007 Dean Hoge
2008 Mark Chaves
2009 Katherine Meyer
2010 James Beckford
2011 Rhys H. Williams
2012 Michele Dillon
2013 James Richardson
2014 Fenggang Yang
2015 Corwin Smidt
2016 Nancy Nason-Clark
2017 Korie L. Edwards
2018 Elaine Howard Ecklund
2019 Laura Olson
2020 Prema Kurien

PRESIDENTS OF RRA

1959 Lauris B. Whitman
1962 Walter Kloetzli
1965 Paul Mundy
1967 George W. Kaslow, Jr.
1971 Thomas G. Gannon
1972 James E. Dittes
1974 Earl D. Brewer
1976 Ross P. Scherer
1978 Barbara J.W. Hargrove
1980 Dean Hoge
1981 G. Douglass Lewis
1982 David O. Moberg
1983 Jackson W. Carroll
1984 William McKinney
1985 Constant H. Jacquet
1987 Hart M. Nelson
1989 James D. Davidson, Jr.
1991 Wade Clark Roof
1993 Peggy L. Shriver
1995 Benton Johnson
1997 Carl S. Dudley
1999 Edward C. Lehman, Jr.
2000 D. Paul Johnson
2002 Nancy Nason-Clark
2004 Daniel V.A. Olson
2006 Kirk Hadaway
2008 Keith Wulff
2010 John P. Bartkowski
2012 Joy Charlton
2014 Jack Marcum
2016 Scott Thumma
2018 Patricia A. Wittberg
2020 Melinda Denton

An aerial photograph of the Baltimore skyline at sunset. The sky is a mix of orange, yellow, and blue. The city is filled with numerous skyscrapers and buildings, many of which are illuminated with their interior lights. The water of the harbor is visible in the foreground, reflecting the city lights and the sunset colors. The overall scene is a vibrant and detailed representation of the city's urban landscape.

SSSR + RRA

NOVEMBER 11-13, 2022

Renaissance Baltimore Harborplace Hotel

BALTIMORE, MARYLAND